



Glan Avon Mews, Harlow, CM17 9DZ
£500,000

4 2 1 C

Glan Avon Mews, Harlow, CM17 9DZ

This well presented four bedroom detached family home includes a garage and driveway and is located in the convenient and popular area of Potter Street, Harlow. On the ground floor there is a large entrance hallway leading to a bright lounge, stunning kitchen/diner with a range of fitted wall and base units with integrated appliances and a breakfast bar, plus a cloakroom/WC. Upstairs there are four bedrooms, with a beautiful en-suite to the master and a matching family bathroom with a white three piece suite. The west facing rear garden is mainly laid to lawn with a patio area, access to the back of the garage and side access out to the driveway. Kingsdon Lane is located just off Potter Street, with local schools, shops and open fields within walking distance, plus the M11 close by.

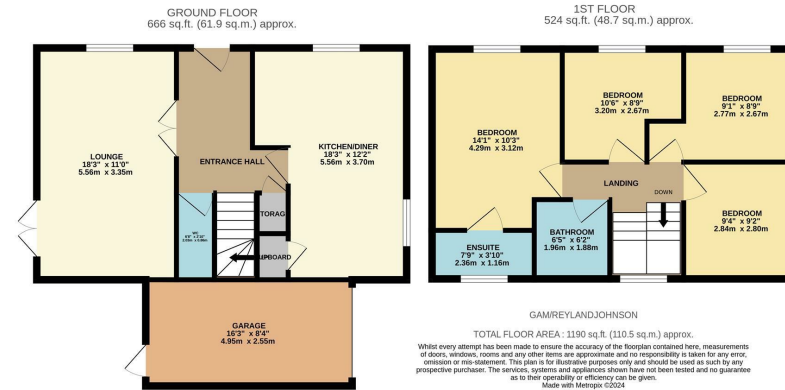

Energy Efficiency Rating		Current	Potential
Very energy efficient - lower running costs			
(92 plus) A			
(81-91) B			85
(69-80) C		69	
(55-68) D			
(39-54) E			
(21-38) F			
(1-20) G			
Not energy efficient - higher running costs			
England & Wales	EU Directive 2002/91/EC		

Environmental Impact (CO ₂) Rating		Current	Potential
Very environmentally friendly - lower CO ₂ emissions			
(81-91) A			
(69-80) B			
(55-68) C			
(39-54) D			
(21-38) E			
(1-20) F			
(1-20) G			
Not environmentally friendly - higher CO ₂ emissions			
England & Wales	EU Directive 2002/91/EC		

These particulars, whilst believed to be accurate are set out as a general outline only for guidance and do not constitute any part of an offer or contract. Intending purchasers should not rely on them as statements of representation of fact, but must satisfy themselves by inspection or otherwise as to their accuracy. No person in this firm's employment has the authority to make or give any representation or warranty in respect of the property.

T. 01279 216216 E. info@rjestateagents.co.uk

1 Acorn Mews, Harlow, Essex, CM18 6NA www.rjestateagents.co.uk