



CARVER
RESIDENTIAL
Sales · Lettings · Property Management

Valley Road
Northallerton, DL6 1HW

Asking price £199,950

House - Terraced
3 Bedroom/s
1 Bathroom/s

A well presented three bedroomed end of terrace house with a large rear garden situated in a cul de sac location overlooking a communal green area to the front. The property benefits from gas fired central heating and double glazing and the accommodation includes a spacious living room with French doors leading to the conservatory, dining room and kitchen/breakfast room fitted with a range of wall and based units together with integrated oven and five ring hob. There are three bedrooms all having built in wardrobe/storage cupboards. The family bathroom is fitted with a white suite with shower over the bath. On the landing there is an airing cupboard housing the boiler together with radiator. The loft is partially boarded and accessed via a drop down ladder. Externally there is a front garden and gate to the side leading to the good sized west facing rear garden.





- Three bedroomed end terrace house
- Spacious living room and separate dining room
- Gas central heating and double glazing
- Cul de sac location overlooking a communal green area to the front
- Well presented living accommodation
- Conservatory opening to and overlooking the rear garden
- Large private rear garden

GENERAL INFORMATION

Tenure: Freehold

Services: Gas central heating, mains electric, water and drainage

Double glazing

Local Authority: North Yorkshire Band B

Buyer(s) Identification Checks

Should a purchaser(s) have an offer accepted on a property marketed by Carver Residential they will need to undertake an identification check. This is done to meet our obligation under Anti Money Laundering Regulations (AML) and is a legal requirement. We use a specialist third party service to verify your identity, this is not a credit check and will have no effect on credit history. The cost of these checks is £36 inc. VAT per buyer, which is paid in advance, when an offer is agreed and prior to a sales memorandum being issued. This charge is non-refundable.

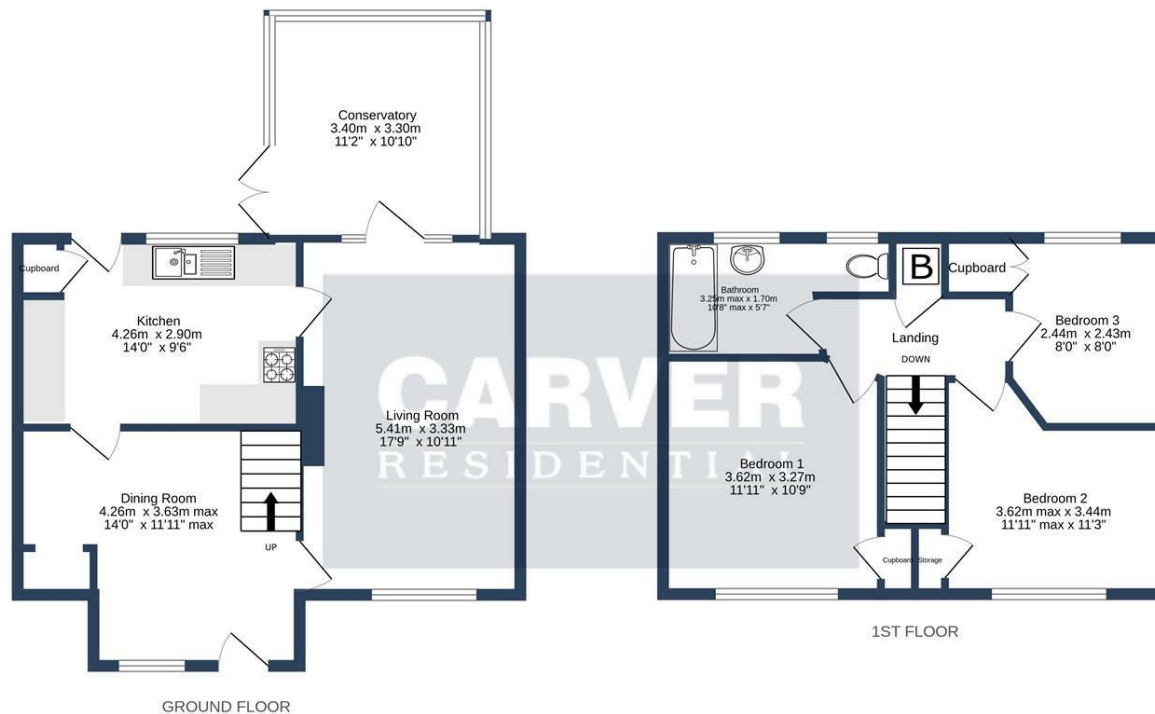

VALLEY ROAD, NORTHALLERTON, DL6 1HW.

Whilst every attempt has been made to ensure the accuracy of the floorplan contained here, measurements of doors, windows, rooms and any other items are approximate and no responsibility is taken for any error, omission or mis-statement. This plan is for illustrative purposes only and should be used as such by any prospective purchaser. The services, systems and appliances shown have not been tested and no guarantee as to their operability or efficiency can be given.
Made with Metropix ©2025

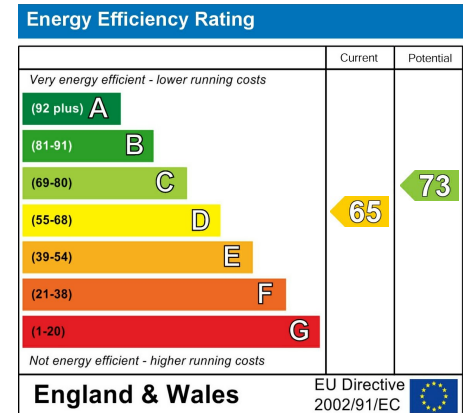

We can search 1,000s of mortgages for you

It could take just 15 minutes with one of our specialist advisers:
Call: 01325 380088. Visit: Any of our Offices. Online: www.mortgageadvicebureau.com/carver



Your home may be repossessed if you do not keep up repayments on your mortgage.
There will be a fee for mortgage advice. The actual amount you pay will depend upon your circumstances.
The fee is up to 1% but a typical fee is 0.3% of the amount borrowed

MAB 6202



These particulars do not constitute any part of an offer or contract. None of the statements contained in these particulars are to be relied on as statements or representations of fact and any intending purchaser must satisfy himself by inspection or otherwise to the correctness of each of the statements contained in these particulars. The vendor does not make or give, and neither Nick & Gordon Carver Residential or Commercial, Nick & Gordon Carver, nor any person in their employment has any authority to make or give any representation or warranty whatever in relation to this property



14 Duke Street, Darlington
Co Durham, DL3 7AA
01325 357807
sales@carvergroup.co.uk

63 Dalton Way, Newton Aycliffe
Co Durham DL5 4NB
01325 320676
aycliffe@carvergroup.co.uk

41 Market Place, Richmond
North Yorkshire, DL10 4QL
01748 825317
richmond@carvergroup.co.uk

219 High Street, Northallerton
North Yorkshire DL7 8LW
01609 777710
northallerton@carvergroup.co.uk

www.carvergroup.co.uk