



**CARVER**  
RESIDENTIAL  
Sales · Lettings · Property Management

Richmond Rise  
Northallerton, DL7 8JR

**Offers in the region of £239,950**

Bungalow - Detached  
3 Bedroom/s  
1 Bathroom/s

A spacious three bedroomed detached bungalow in need of complete refurbishment. The property is located in a popular location and benefits from gas fired central heating and double glazing. The accommodation includes an entrance hall, spacious living room / dining room, kitchen, conservatory, inner hall, three bedrooms and family bathroom. Externally there are front, side and rear gardens together with a driveway providing ample off street parking and access to the garage. There have been some adaptations made for wheelchair access including ramp access to the rear. The property is well positioned for anyone requiring access to the main line railway station, transport links and local amenities. No onward chain





- Three bedroomed detached bungalow
- Gas fired central heating and double glazing
- Driveway providing off street parking and garage
- In need of complete refurbishment
- No onward chain
- Popular residential location
- Spacious living room and separate conservatory
- Gardens to the front side and rear
- Vacant possession
- Located within easy reach of main line railway station

#### GENERAL INFORMATION

Tenure: Freehold

Services: Gas central heating, mains electric, water and drainage.

Double glazing

Local Authority: North Yorkshire Band C

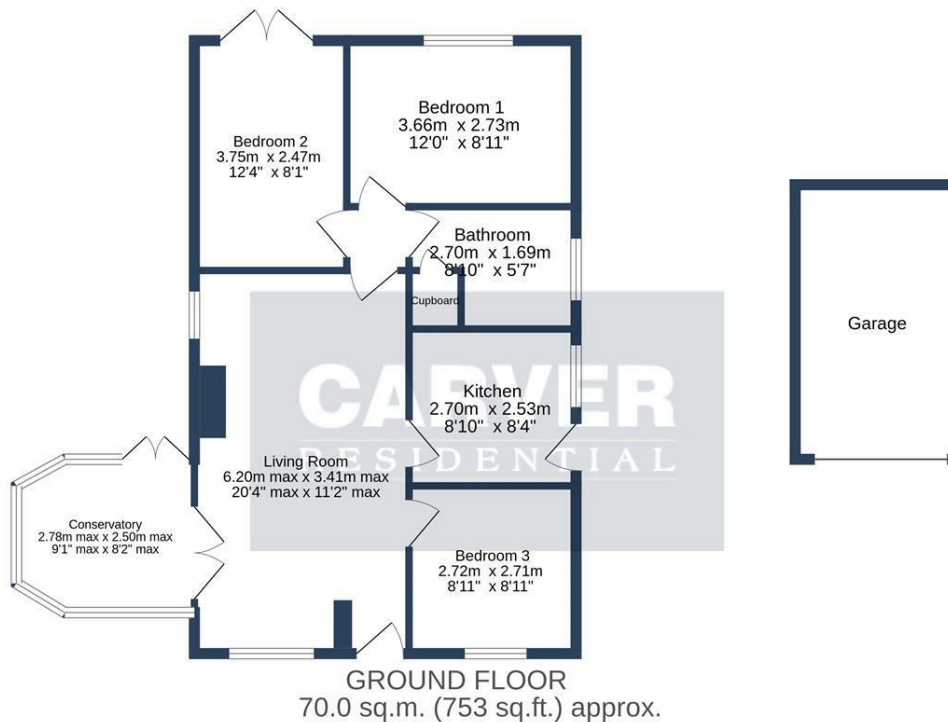

Energy Efficiency Rating		
	Current	Potential
Very energy efficient - lower running costs		
(92 plus) <b>A</b>		
(81-91) <b>B</b>		
(69-80) <b>C</b>		
(55-68) <b>D</b>		
(39-54) <b>E</b>		
(21-38) <b>F</b>		
(1-20) <b>G</b>		
Not energy efficient - higher running costs		
<b>England &amp; Wales</b>	EU Directive 2002/91/EC	

RICHMOND RISE, NORTHALLERTON. DL7 8JR.

TOTAL FLOOR AREA: 70.0 sq.m. (753 sq.ft.) approx.

Whilst every attempt has been made to ensure the accuracy of the floorplan contained here, measurements of doors, windows, rooms and any other items are approximate and no responsibility is taken for any error, omission or mis-statement. This plan is for illustrative purposes only and should be used as such by any prospective purchaser. The services, systems and appliances shown have not been tested and no guarantee as to their operability or efficiency can be given.  
Made with Metropix ©2024

**We can search 1,000s of mortgages for you**

It could take just 15 minutes with one of our specialist advisers:  
Call: 01325 380088. Visit: Any of our Offices. Online: [www.mortgageadvicebureau.com/carver](http://www.mortgageadvicebureau.com/carver)



Your home may be repossessed if you do not keep up repayments on your mortgage. There will be a fee for mortgage advice. The actual amount you pay will depend upon your circumstances. The fee is up to 1% but a typical fee is 0.3% of the amount borrowed

MAB 6202



These particulars do not constitute any part of an offer or contract. None of the statements contained in these particulars are to be relied on as statements or representations of fact and any intending purchaser must satisfy himself by inspection or otherwise to the correctness of each of the statements contained in these particulars. The vendor does not make or give, and neither Nick & Gordon Carver Residential or Commercial, Nick & Gordon Carver, nor any person in their employment has any authority to make or give any representation or warranty whatever in relation to this property



**14 Duke Street, Darlington**  
Co Durham, DL3 7AA  
01325 357807  
[sales@carvergroup.co.uk](mailto:sales@carvergroup.co.uk)

**43 Dalton Way, Newton Aycliffe**  
Co Durham DL5 4DJ  
01325 320676  
[aycliffe@carvergroup.co.uk](mailto:aycliffe@carvergroup.co.uk)

**41 Market Place, Richmond**  
North Yorkshire, DL10 4QL  
01748 825317  
[richmond@carvergroup.co.uk](mailto:richmond@carvergroup.co.uk)

**219 High Street, Northallerton**  
North Yorkshire DL7 8LW  
01609 777710  
[northallerton@carvergroup.co.uk](mailto:northallerton@carvergroup.co.uk)

[www.carvergroup.co.uk](http://www.carvergroup.co.uk)