



**CARVER**  
RESIDENTIAL  
Sales · Lettings · Property Management

Arden Court  
Northallerton, DL6 1EW

**Offers in the region of £69,950**

Flat - Retirement  
1 Bedroom/s  
1 Bathroom/s

A spacious and well appointed one double bed roomed first floor apartment located within a purpose built retirement development close to Northallerton High Street. The property has electric heating and double glazing and the accommodation includes a reception hall with large storage cupboard, spacious living room / dining room which overlooks communal garden, fitted kitchen with integrated oven and hob, double bedroom with built in wardrobe and a refurbished shower room / wc with shower cubical, wc and sink with vanity units below. There is a lift within the building together with communal residents lounge and laundry room. There is also an onsite manager between 9am and 4pm Mon - Fri. Externally there are communal gardens and parking.





- First floor one double bedroomed apartment with lift access
- Double bedroomed with built in wardrobe
- Fitted kitchen with integrated oven and hob
- Purpose built retirement development with onsite manager ( Tues and Thurs 8.30am to 1.30pm )
- Communal gardens and parking
- Spacious living room / dining room
- Refurbished shower room / wc
- Well appointed living accommodation
- Communal residential lounge and laundry room

**GENERAL INFORMATION**

Tenure: Leasehold. 125yr lease from 01/07/1989. Ground Rent £420 per year. Service Charge £2930 per year  
 Services: Electric heating, mains electric, water and drainage.  
 Double glazing.  
 Local Authority: North Yorkshire Band B  
 Occupancy age restriction - 60yr or over for main owner & 55yr or over for partner.  
 Development manager on site Tues and Thurs 8.30am until 1.30pm

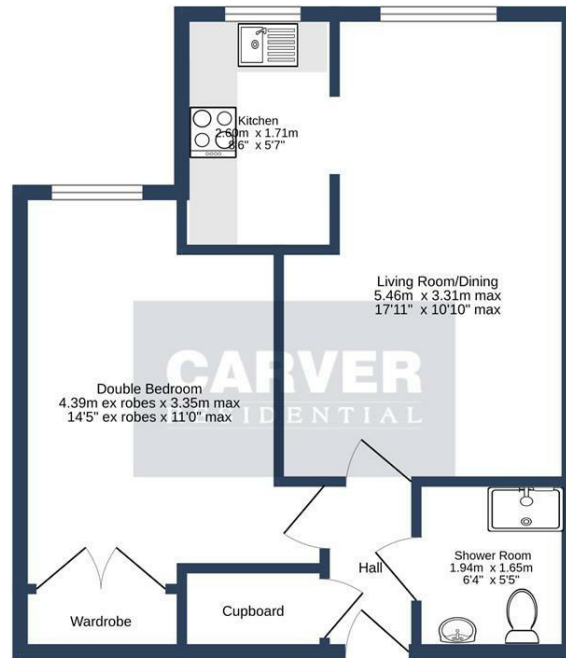

FIRST FLOOR  
42.8 sq.m. (461 sq.ft.) approx.

ARDEN COURT, NORTHALLERTON, DL6 1EW.

TOTAL FLOOR AREA - 42.8 sq.m. (461 sq.ft.) approx.

While every attempt has been made to ensure the accuracy of the footprint contained here, measurements of doors, windows, rooms and any other items are approximate and no responsibility is taken for any error, omission or mis-statement. This plan is for illustrative purposes only and should be used as such by any prospective purchaser. The services, systems and appliances shown have not been tested and no guarantee as to their operability or efficiency can be given.  
Made with Metropix ©2024

Energy Efficiency Rating		
	Current	Potential
Very energy efficient - lower running costs		
(92 plus) <b>A</b>		
(81-91) <b>B</b>	83	86
(69-80) <b>C</b>		
(55-68) <b>D</b>		
(39-54) <b>E</b>		
(21-38) <b>F</b>		
(1-20) <b>G</b>		
Not energy efficient - higher running costs		
<b>England &amp; Wales</b>	EU Directive 2002/91/EC	

We can search 1,000s of mortgages for you

It could take just 15 minutes with one of our specialist advisers:  
Call: 01325 380088. Visit: Any of our Offices. Online: [www.mortgageadvicebureau.com/carver](http://www.mortgageadvicebureau.com/carver)



Your home may be repossessed if you do not keep up repayments on your mortgage. There will be a fee for mortgage advice. The actual amount you pay will depend upon your circumstances. The fee is up to 1% but a typical fee is 0.3% of the amount borrowed

MAB 6202



These particulars do not constitute any part of an offer or contract. None of the statements contained in these particulars are to be relied on as statements or representations of fact and any intending purchaser must satisfy himself by inspection or otherwise to the correctness of each of the statements contained in these particulars. The vendor does not make or give, and neither Nick & Gordon Carver Residential or Commercial, Nick & Gordon Carver, nor any person in their employment has any authority to make or give any representation or warranty whatever in relation to this property



14 Duke Street, Darlington  
County Durham, DL3 7AA  
Tel: 01325 357807  
[sales@carvergroup.co.uk](mailto:sales@carvergroup.co.uk)

26 Market Place, Richmond  
North Yorkshire, DL10 4QG  
Tel: 01748 825317  
[richmond@carvergroup.co.uk](mailto:richmond@carvergroup.co.uk)

43 Dalton Way, Newton Aycliffe  
County Durham, DL5 4DJ  
Tel: 01325 320676  
[aycliffe@carvergroup.co.uk](mailto:aycliffe@carvergroup.co.uk)

219 High Street, Northallerton  
North Yorkshire, DL7 8LW  
Tel: 01609 777710  
[northallerton@carvergroup.co.uk](mailto:northallerton@carvergroup.co.uk)

[www.carvergroup.co.uk](http://www.carvergroup.co.uk)