



5 Yew Tree Close, Beaconsfield

Guide Price £525,000

Ashington Page

A Charming end terrace property ideally tucked away in a peaceful location within a short stroll to Beaconsfield Old Town with its variety of local amenities. The property is well maintained throughout, benefits from open plan living, private garden, garage and off street parking. The New Town with its train station and direct links to London Marylebone is a short walk away. The property sits in catchment for excellent primary, secondary and grammar schools. Freehold

EPC C

Council tax D

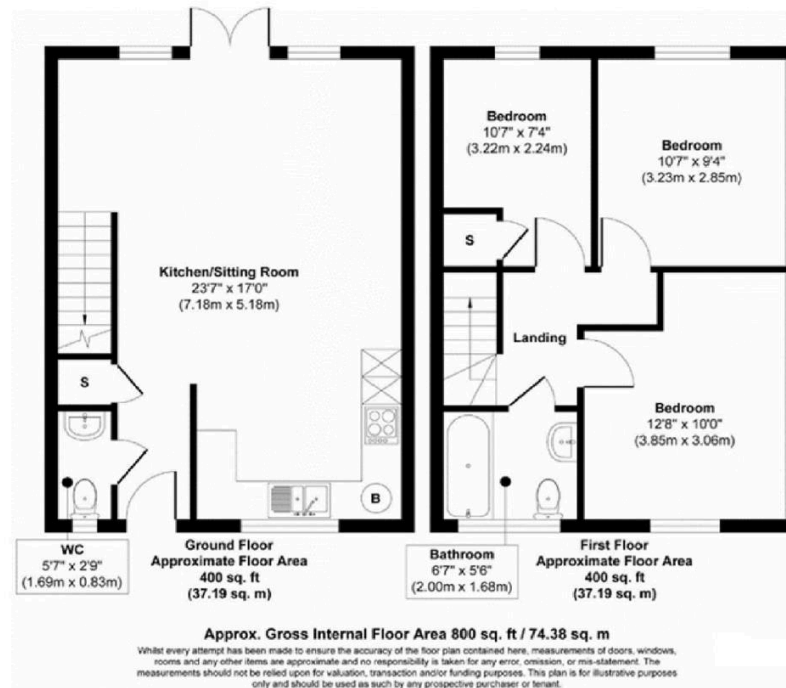

Garage 114 sq ft / 34.74 sq m

These particulars are for guidance only. They are prepared and issued in good faith and are intended to give a fair summary of the property. Any description should not be relied on as a statement or representation of fact or that the property, or its services, are in good condition. The photographs show only certain parts of the property at the time they were taken. Any areas, measurements or distance given are approximate only. Any reference to alterations to, or use of, any part of the property is not a statement that any necessary planning, building regulations or other consent has been obtained. These matters must be verified by an intending purchaser. All statements contained in these particulars in relation to the property are made without responsibility of Ashington Page or its clients. Neither Ashington Page (nor any joint agents) nor any of their employees has any authority to make or give any representation or warranty whatsoever in relation to the property



01494 680018
 info@ashingtonpage.co.uk
 www.AshingtonPage.co.uk

