

25  
YEARS

SERVING  
BEACONSFIELD  
SINCE 1998



Flat 3, Holmewood, 40 Gregories Road £750,000

*Ashington Page*



**NO CHAIN!** Situated in the heart of Beaconsfield New Town, Holmewood is a modern development of just 13 apartments, offering a blend of convenience and modern living. This spacious ground-floor apartment benefits from its own private entrance and terrace, along with two allocated parking spaces within a secure gated driveway. The beautifully maintained communal gardens and lift access to all floors further enhance the appeal of this sought-after residence.

- Tenure: Leasehold
- Lease Expiry: 24/03/2107
- Ground Rent: £1,000.00 per year
- Service Charge: £1,000.00 per year
- EPC B
- Council Tax Band G

These particulars are for guidance only. They are prepared and issued in good faith and are intended to give a fair summary of the property. Any description should not be relied on as a statement or representation of fact or that the property, or its services, are in good condition. The photographs show only certain parts of the property at the time they were taken. Any areas, measurements or distance given are approximate only. Any reference to alterations to, or use of, any part of the property is not a statement that any necessary planning, building regulations or other consent has been obtained. These matters must be verified by an intending purchaser. All statements contained in these particulars in relation to the property are made without responsibility of Ashington Page or its clients. Neither Ashington Page (nor any joint agents) nor any of their employees has any authority to make or give any representation or warranty whatsoever in relation to the property

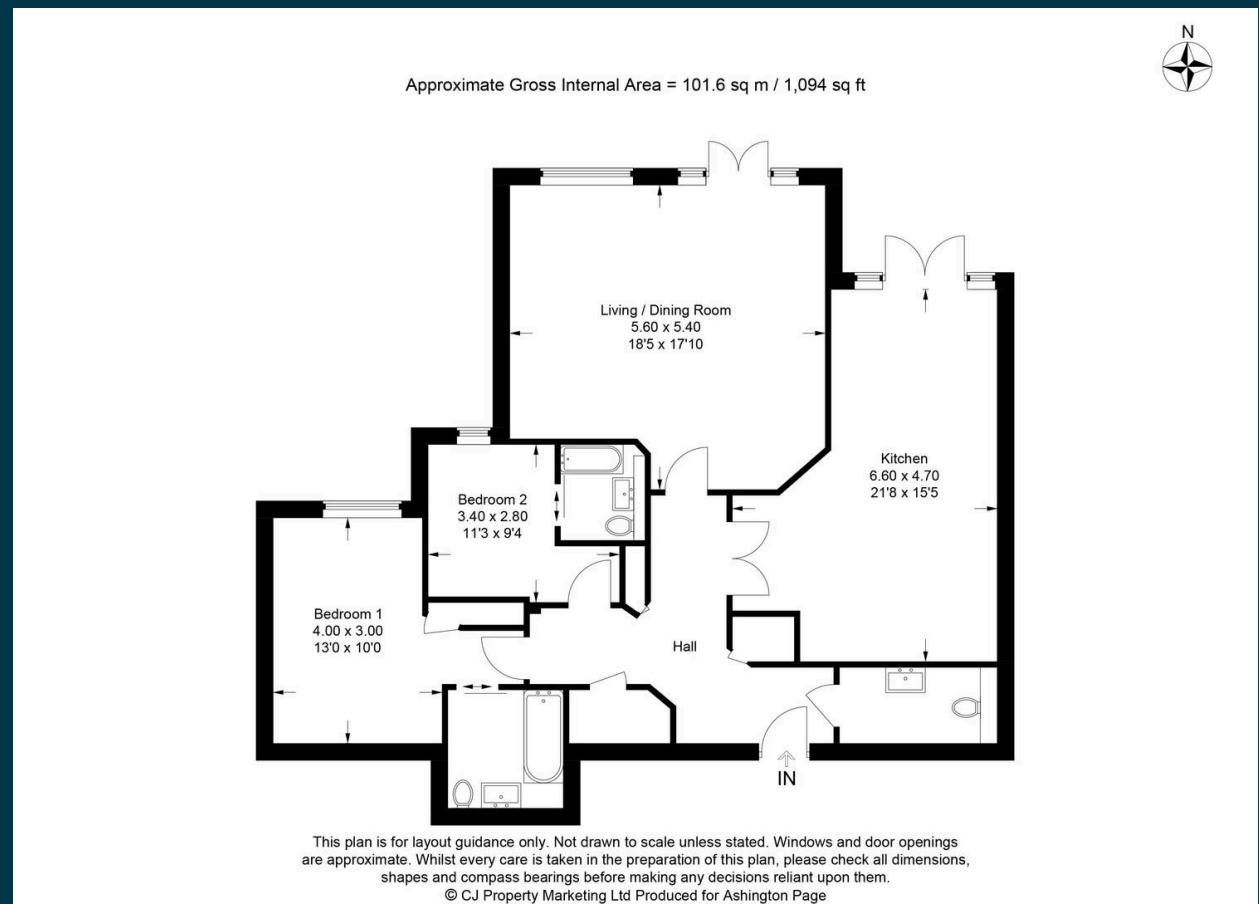

01494 680018  
[info@ashingtonpage.co.uk](mailto:info@ashingtonpage.co.uk)  
[www.AshingtonPage.co.uk](http://www.AshingtonPage.co.uk)