



16 Howard Crescent, Seer Green

Guide Price £1,250,000

Ashington Page

No chain! A spacious five-bedroom detached property is perfectly positioned within an excellent school catchment area, close to local amenities, and within easy reach of the train station providing swift access to London Marylebone. The block-paved driveway has space for two vehicles in front of the garage. The rear garden features a large patio area ideal for entertaining, with the remainder laid to lawn and bordered by panel fencing and mature shrubs. The garden backs onto farmland and there are miles of countryside walks from the doorstep.

EPC C

Council Tax Band F

Tenure: Freehold

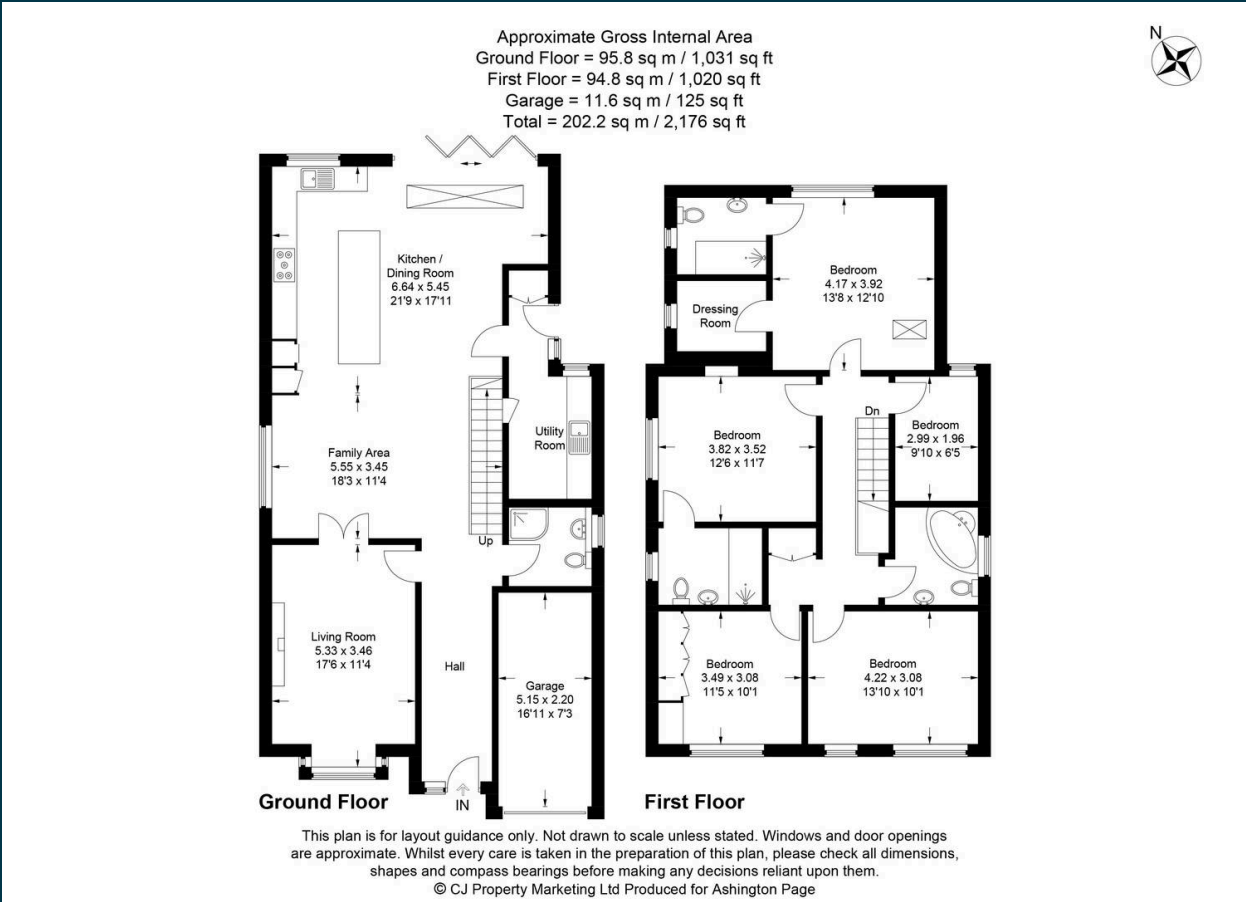

These particulars are for guidance only. They are prepared and issued in good faith and are intended to give a fair summary of the property. Any description should not be relied on as a statement or representation of fact or that the property, or its services, are in good condition. The photographs show only certain parts of the property at the time they were taken. Any areas, measurements or distance given are approximate only. Any reference to alterations to, or use of, any part of the property is not a statement that any necessary planning, building regulations or other consent has been obtained. These matters must be verified by an intending purchaser. All statements contained in these particulars in relation to the property are made without responsibility of Ashington Page or its clients. Neither Ashington Page (nor any joint agents) nor any of their employees has any authority to make or give any representation or warranty whatsoever in relation to the property



01494 680018
info@ashingtonpage.co.uk
www.AshingtonPage.co.uk

