

25
YEARS

SERVING
BEACONSFIELD
SINCE 1998



Flat 9, The Mill Coaters Lane, Wooburn Green

Guide Price £400,000

Ashington Page

Fabulous 3 bedroom, 2 bathroom apartment with views over the gardens and picturesque Wye Valley. This stunning, contemporary first floor apartment is light and spacious and benefits from a lift and 2 allocated parking spaces. It is ideally situated within a short walk to the village centre and just a stones throw away from the David Lloyd Health Club.

LEASE: Leasehold with 125 years from 1st January 2002

COUNCIL TAX BAND: D

EPC RATING: C

SERVICE CHARGE - £3,436 / per year

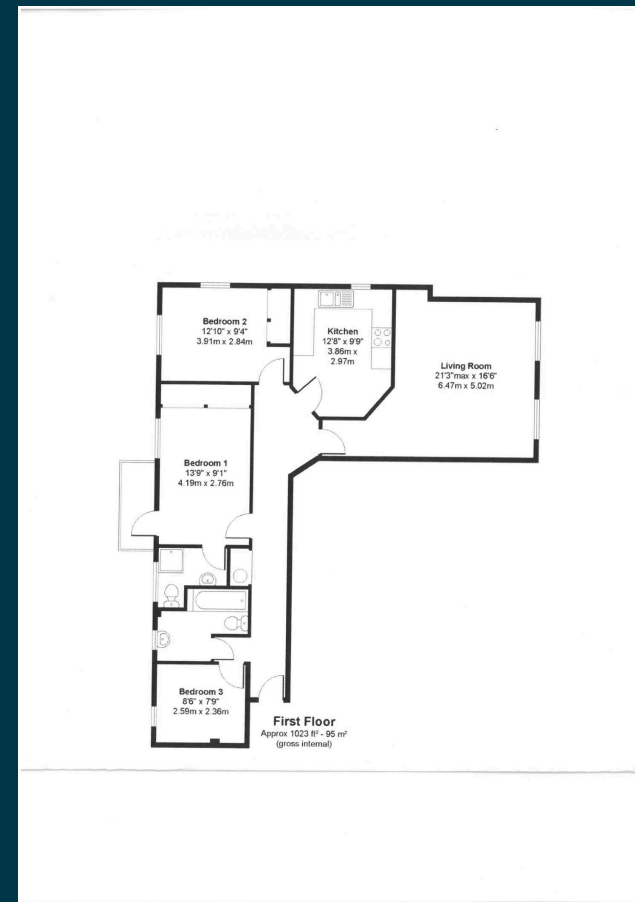

These particulars are for guidance only. They are prepared and issued in good faith and are intended to give a fair summary of the property. Any description should not be relied on as a statement or representation of fact or that the property, or its services, are in good condition. The photographs show only certain parts of the property at the time they were taken. Any areas, measurements or distance given are approximate only. Any reference to alterations to, or use of, any part of the property is not a statement that any necessary planning, building regulations or other consent has been obtained. These matters must be verified by an intending purchaser. All statements contained in these particulars in relation to the property are made without responsibility of Ashington Page or its clients. Neither Ashington Page (nor any joint agents) nor any of their employees has any authority to make or give any representation or warranty whatsoever in relation to the property



ially Staged

01494 680018
info@ashingtonpage.co.uk
www.AshingtonPage.co.uk