



HIGH STREET
GODSTONE, SURREY, RH9 8LW

Rayners are delighted to present this quaint two-bedroom Grade II listed chain free cottage, situated in the picturesque village of Godstone. The property offers flexible accommodation, including a fitted kitchen and dining area, and a cozy lounge that overlooks the courtyard garden. Additionally, there is a hardstanding area providing convenient parking.

With its attractive asking price, this property is a must-see. The popular village of Godstone boasts excellent walks along the North Downs and features charming pubs, convenience stores, a primary school, a nursery, and coffee shops. For a wider range of shopping and services, Caterham and Oxted are easily accessible.

Gatwick Airport is located to the southwest, and Junction 6, to the north of Godstone, provides access to the M23/M25 motorway network. The area is well-served by local schools, including primary schools in Blindley Heath and South Godstone, Oxted County, and several renowned private schools such as Lingfield College, Woldingham School, Caterham School, and Reigate Grammar, along with Hawthorns and Hazelwood prep schools nearby.

Don't miss this opportunity to own a charming cottage in a highly desirable location.

Tenure: Freehold

Grade II listed building.

Local Authority: Tandridge District Council

Council Tax Band: D

EPC Rating: C

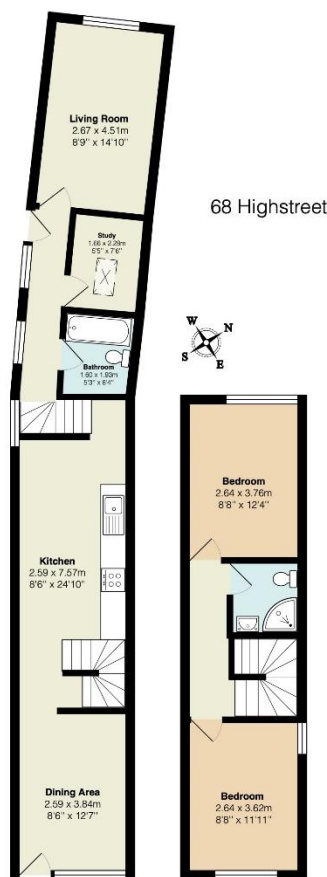

Total Area: 84.6 m² ... 910 ft²

All measurements are approximate and for display purposes only

SALES

2 GLEBE ROAD, WARLINGHAM, SURREY, CR6 9NJ

01883 622 258

enquiries@raynersproperties.com

www.raynersproperties.com

IMPORTANT: we would like to inform prospective purchasers that these sales particulars have been prepared as a general guide only. A detailed survey has not been carried out, nor the services, appliances and fittings tested. Room sizes should not be relied upon for furnishing purposes and are approximate. If floor plans are included, they are for guidance only and illustration purposes only and may not be to scale. If there are any important matters likely to affect your decision to buy, please contact us before viewing the property. R772

RAYNERS
TOWN & COUNTRY