



The Maltings, Carpenters Lane, Hadlow, Kent, TN11 0DQ

Guide Price £230,000

When experience counts...

est. 1828  
**bracketts**



Offered for sale is this fantastic sized, two-bedroom apartment situated on the first floor within a popular building which is located in the centre of the charming Village of Hadlow. The property comprises entrance hallway, two good sized double bedrooms, bathroom and an open plan kitchen / dining / living space. The building also benefits from having lift access to all levels as well. Outside there is a pretty communal seating area for residents, as well as allocated parking. Being centrally located, this property benefits from being within close proximity to local amenities such as hairdressers, coffee shop, bakery, convenience store and pharmacy. The property is being offered for sale with no onward chain and an internal inspection comes highly recommended.

First Floor Apartment

Two Double Bedrooms

Open Plan Kitchen / Dining & Living

Bathroom

Allocated Parking Space

Communal Seating Area

Central Village Location

Close Proximity To Local Amenities

Easy Access To Nearby Towns





**LOCATION: Tonbridge**

Tonbridge is a thriving market town that has developed over the centuries. It boasts a fine example of a 'Motte and Bailey' Norman castle built in the 13th century, set on the banks of the river Medway with the castle grounds abutting Tonbridge Park offering covered/open air swimming pool, tennis courts, childrens' play areas, miniature railway, putting etc.

Tonbridge town offers an excellent range of retail and leisure activities with many High Street stores and a full complement of banks and building societies, together with a selection of coffee shops, restaurants and local inns.

The mainline station provides fast commuter links into London (Cannon Street/London Bridge/Charing Cross in approximately 40 minutes) with road links to the M20 & M25 motorways via the nearby A26 and A21.

Tonbridge offers first-rate primary and secondary schools (including Grammars and Public Schools) many of which consistently do well in the league tables. There are many places of historical interest in the surrounding areas including Penshurst Place and Gardens, Hever Castle, Knole House and Chartwell (once home to Winston Churchill).

**ADDITIONAL INFORMATION:**

Council Tax Band D

Lease Hold Information – 940 Years remaining

Maintenance Charges - £1680 PA

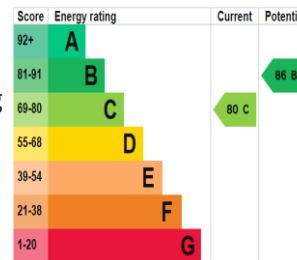

Important Notice: Bracketts, their clients and any joint agents give notice that they have no authority to make or give any representations or warranties in relation to the property. These particulars do not form part of any offer or contract and must not be relied upon as statements or representations of fact. The text, photographs and plans are for guidance only and are not necessarily comprehensive. All areas, measurements or distances are approximate and no responsibility is taken for any error, omission or mis-statement. It should not be assumed that the property has necessary planning, building regulation or other consents and Bracketts have not tested any services, appliances, equipment or facilities. Purchasers must satisfy themselves by inspection or otherwise. Prices, rents or any other charges are exclusive of VAT unless stated to the contrary.

# Carpenters Lane, Hadlow, Tonbridge, TN11

Approximate Area = 785 sq ft / 72.9 sq m

For identification only - Not to scale

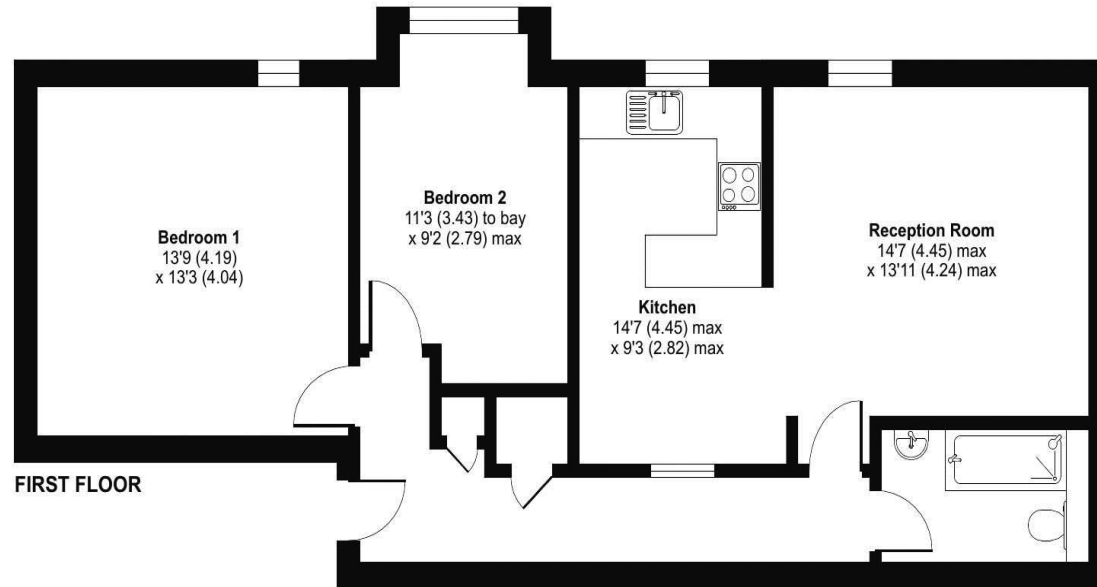

Floor plan produced in accordance with RICS Property Measurement Standards incorporating International Property Measurement Standards (IPMS2 Residential). © rīcheom 2023. Produced for Bracketts llp. REF: 1154197