



**DERBYSHIRE'S**  
— *Village and Country* —

1 Richmond House East Street, Crewkerne,  
Somerset, TA18 7AB

Investors Only - An attractive 1 bedroom first floor flat in the centre of Crewkerne. An ideal investment property with a tenant already in place. The flat comprises: Private entrance, sitting/dining room, kitchen, double bedroom, bathroom, an allocated parking space, visitor parking and communal area with washing lines.

- First Floor Flat
- One Double Bedroom with Wardrobes
- Lounge / Diner
- Kitchen
- Entrance Hall & Landing
- Parking
- Central Heating
- Walking Distance To Town Centre

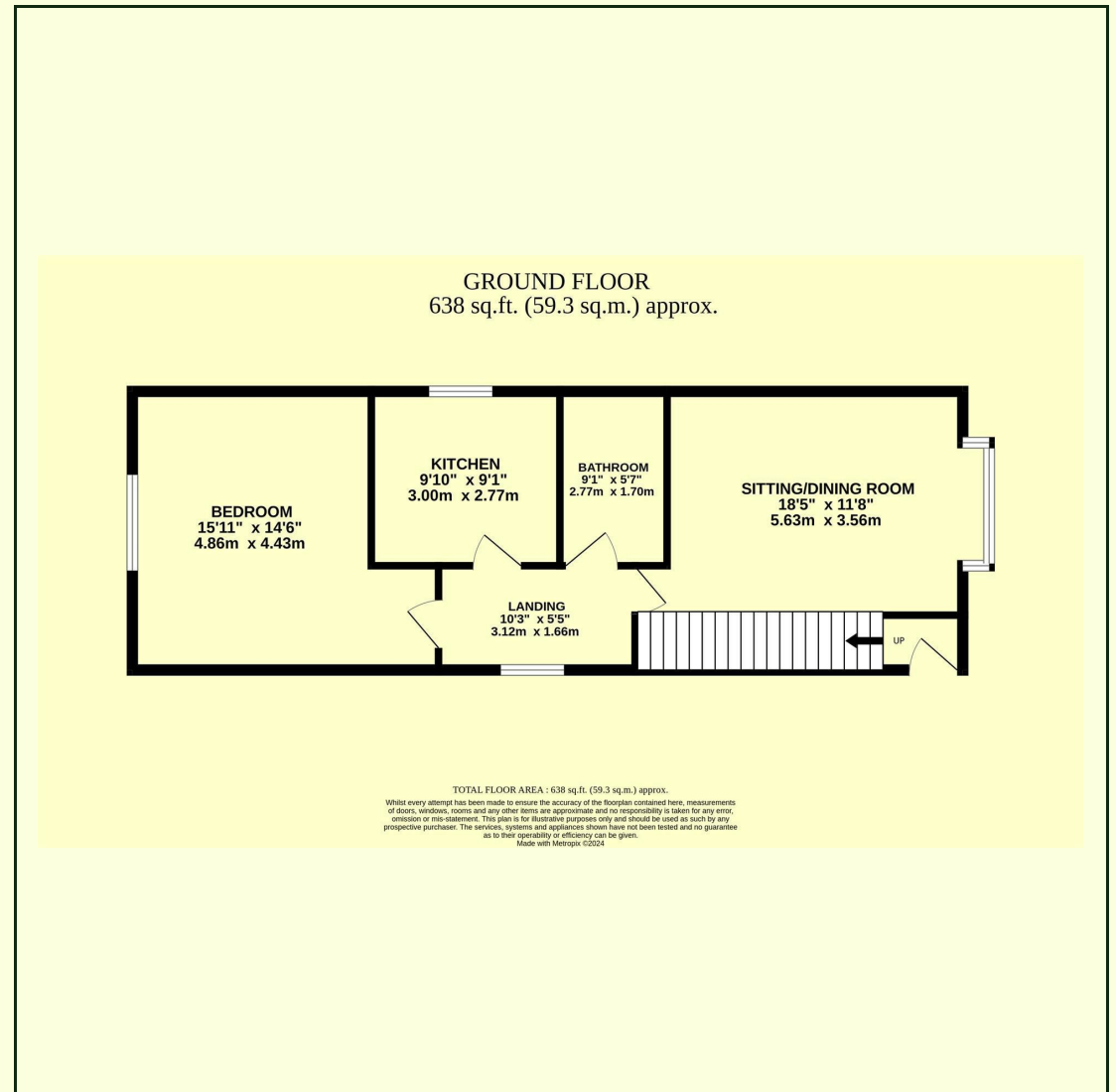

1 Richmond House East Street, Crewkerne, Somerset, TA18 7AB  
**Guide Price £125,000**

## Entrance Hall

Part glazed front door, stairs to first floor.

## Landing

Window to side, radiator, telephone point.

## Sitting/Dining Room

15'5" x 12'5"

Bay window to the front, TV point, 2 x radiators.

## Kitchen

9'10" x 8'6"

Window to the side, a selection of wall and base storage units, 1 1/2 bowl stainless steel sink with drainer and mixer tap, space for a cooker, boiler housing the gas fired central heating system.

## Bedroom

14'1" x 12'5"

Window to the rear, built in wardrobe and further storage, 1 x radiator.

## Bathroom

Panelled bath, pedestal wash hand basin, low level WC, tiled splash backs, extractor.

## Communal Garden

Area of patio, drying area.

## Parking

Allocated parking space

## Services

Mains gas, water, electricity and drainage are connected to the property.

## Local Authority

Somerset Council - Band A

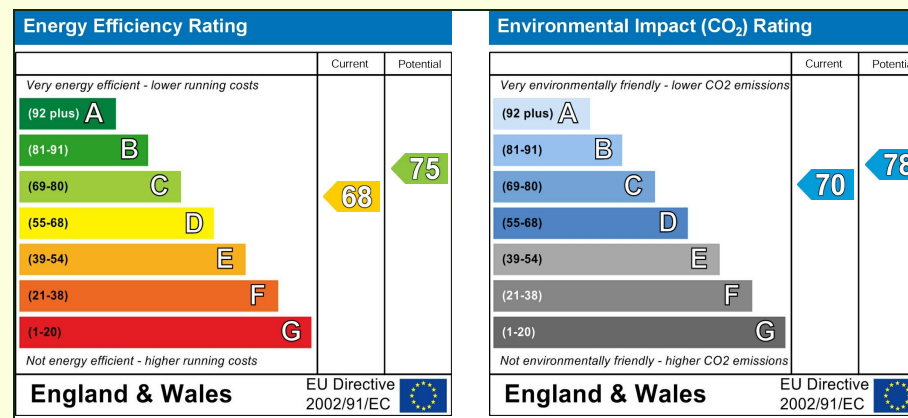



**DERBYSHIRE'S**  
*Village and Country*

7, High Street, Chard, Somerset, TA20 1QF  
www.derbyshires.net 01460 63600