



## King's Quay, SW10

**£876** Per week

A beautifully presented two double bedroom, two bathroom raised ground floor apartment located in the popular Chelsea Harbour Development. Amazing Harbour Views from the terrace, one underground parking space and 24 hour concierge.

One of Chelsea's most prestigious developments with beautiful river views. The property is close to the shops and restaurants of Imperial Wharf and Kings Road.

### Features

- Two Double Bedrooms
- Two Bathrooms
- Harbour Views
- Chelsea Harbour Development
- 24 Hour Concierge
- Underground Parking Space

# King's Quay, London, SW10

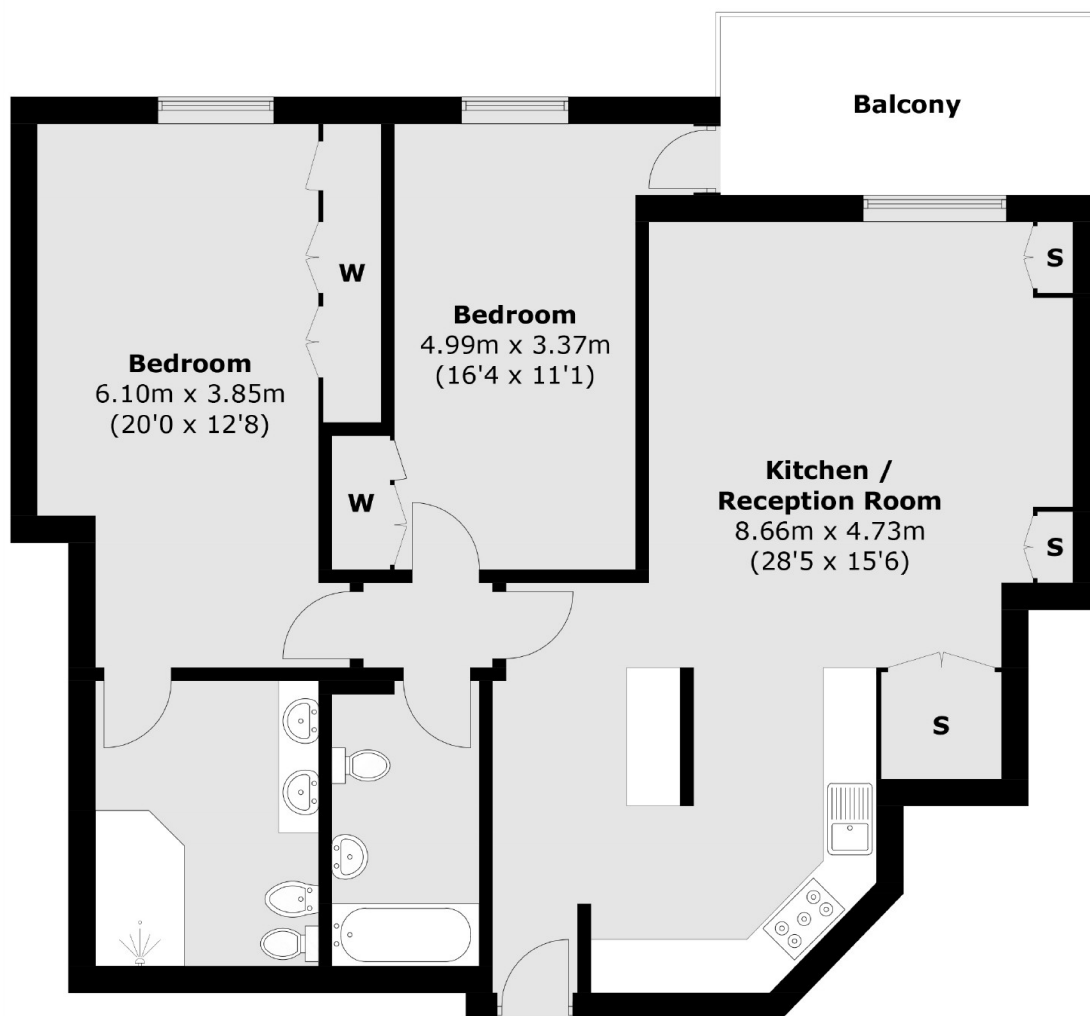

Total area (approx.): 96.1 sq. m (1,034.4 sq. ft)