



## Central Avenue, SW6

£600 Per week

An immaculate one double bedroom apartment with a private balcony and river views set in the desirable Fulham Riverside development, which benefits from landscaped communal gardens and 24-hour concierge.

Fulham Riverside is perfectly located between South Park and Imperial Park, moments away from amenities such as Sainsburys, local cafés and restaurants and the prestigious Hurlingham Club.

### Features

- One Double Bedrooms
- Private Balcony
- River Views
- Private Gym
- Unfurnished
- 24-Hour Concierge

# Central Avenue, London, SW6

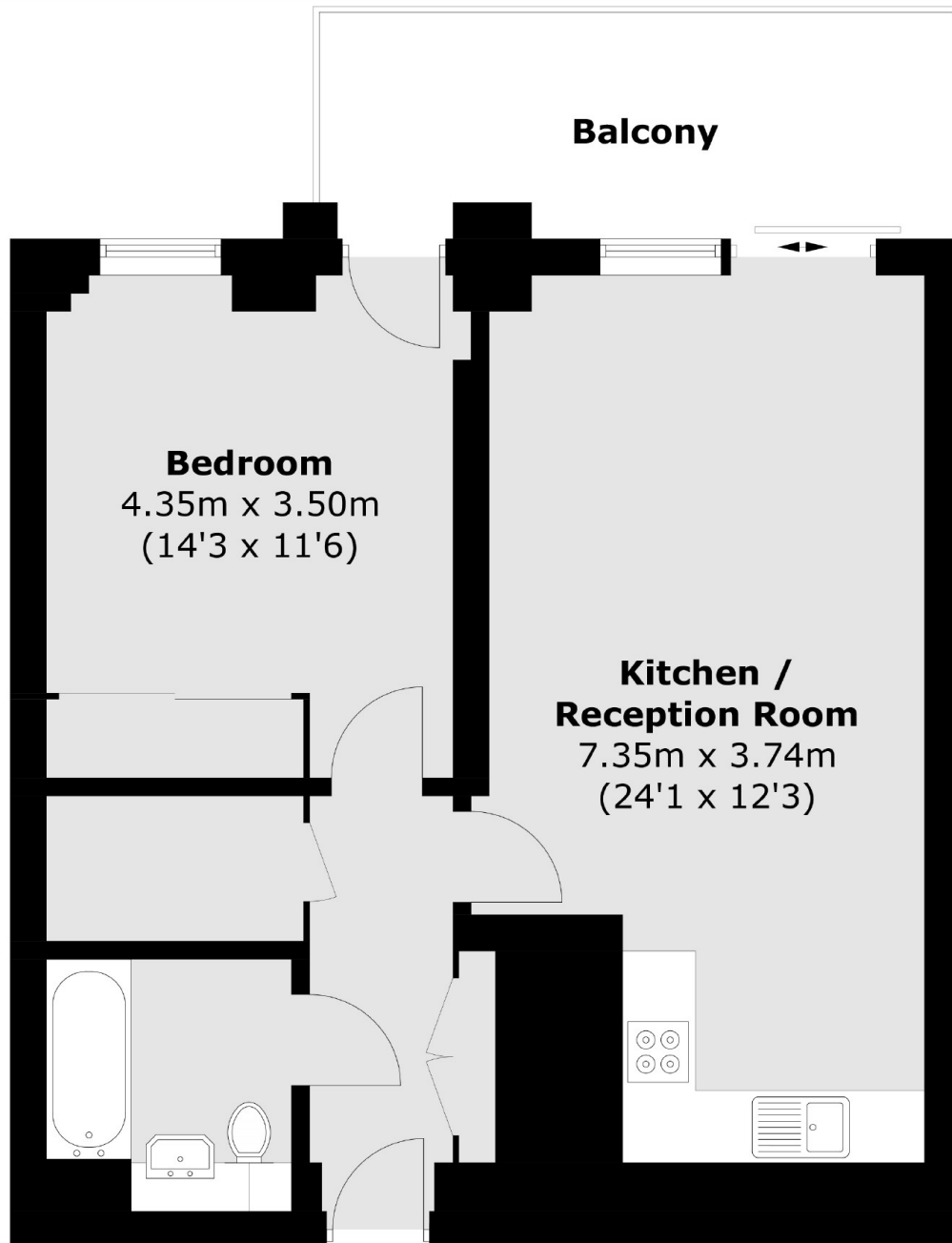

Total area (approx.): 54.8 sq. m (589.9 sq. ft)  
Balcony area (approx.): 9.5 sq. m (102.2 sq. ft)

## Dexters

Chelsea Harbour  
5 Design Centre East  
London  
SW10 0XF

020 7590 9515

Energy Rating: B. We aim to make our particulars both accurate and reliable. However they are not guaranteed; nor do they form part of an offer or contract. If you require clarification on any points then please contact us, especially if you're traveling some distance to view. Please note that appliances and heating systems have not been tested and therefore no warranties can be given as to their good working order.

 **RICS** | Regulated  
Estate Agent  
and Letting Agent

[dexters.co.uk](https://www.dexters.co.uk)