



Imperial Crescent, SW6

£681 Per week

A spacious two double bedroom, two bathroom property in this landmark riverside development with a private balcony overlooking the park.

Imperial Wharf offers a number of excellent restaurants and bars and the river bus service provides direct access to Blackfriars and Putney Piers.

Features

- Two Double Bedrooms
- Two Bathrooms
- Integrated Kitchen
- Private Balcony
- Unfurnished
- 24h/r Concierge

Imperial Crescent, London, SW6

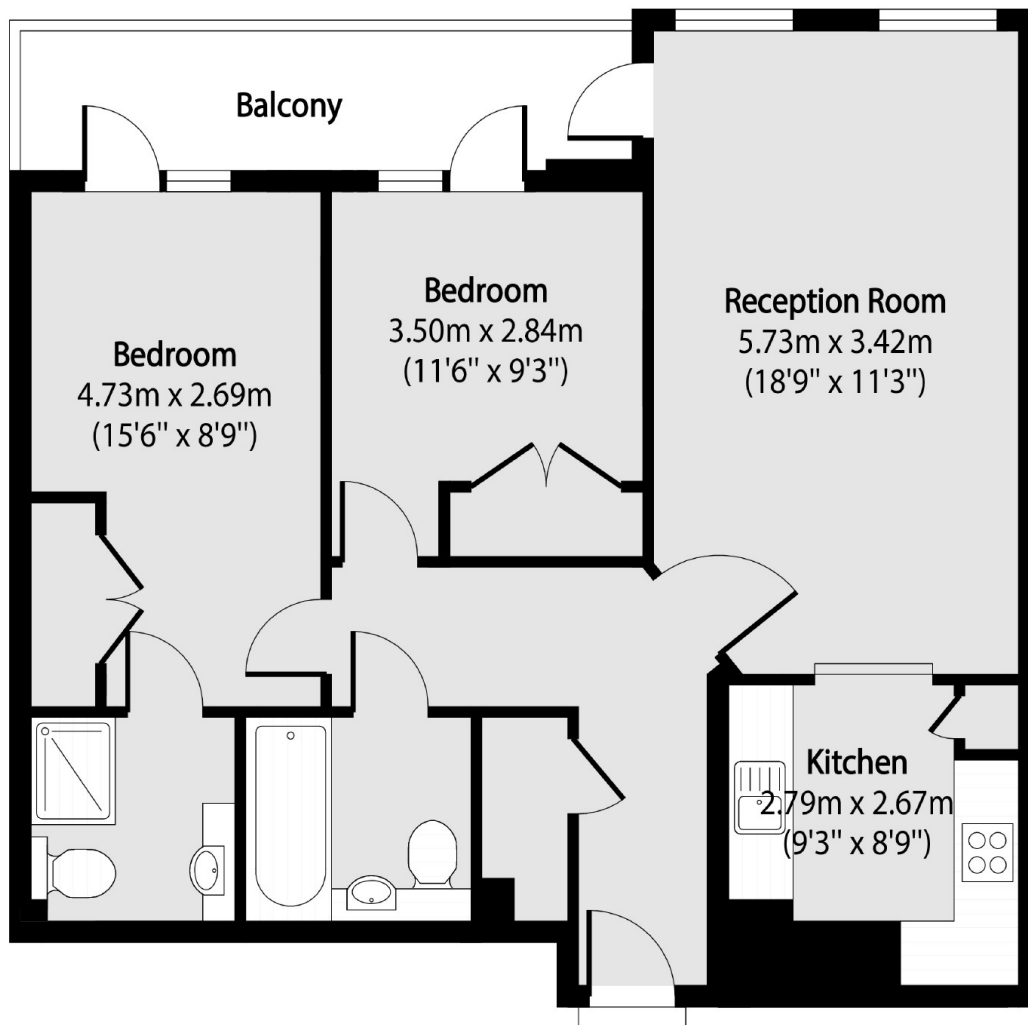

Total area (approx): 70.12 sq m (755 sq. ft)

Balcony total area (approx): 7.33 sq m (79 sq. ft)