



10 Henley Lodge Rydens Road Walton-On-Thames KT12 3AF

£1,600pcm + Initial deposit



Approximate gross internal floor area 861 Sq Ft 80 Sq M

Second floor

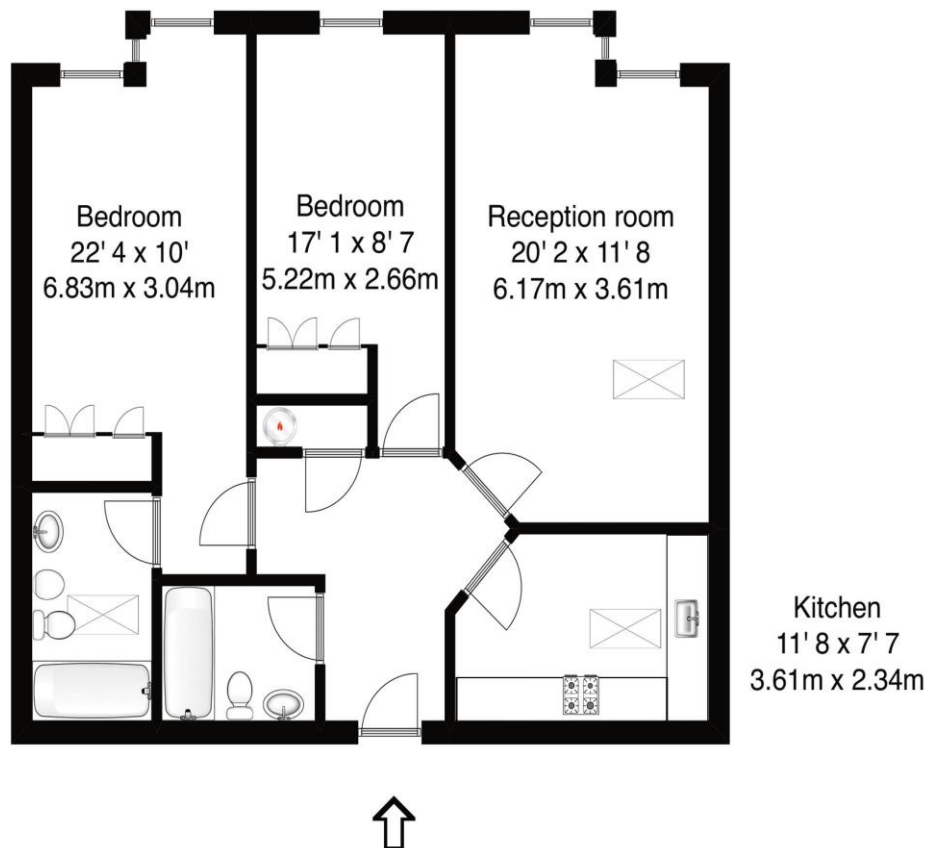

Whilst every attempt has been made to ensure the accuracy of the floor plan contained here, measurements are approximate and no responsibility is taken for any error, omission, or mis-statement. The plan is for illustrative purposes only and should be used as such by any prospective purchaser.

A well-presented two double bedroom flat, set within this attractive modern gated development. The property has just been redecorated and new carpets laid. It comprises a separate kitchen and spacious living room, two double bedrooms — with the main bedroom benefiting from an en-suite bathroom — and a further family bathroom. The block is serviced by a lift and features a secure entry system. Gated parking is available to the rear, with visitor spaces at the front. Conveniently located within walking distance of Walton mainline station.

Available unfurnished, now. EPC Rating C.



AGENTS NOTES: These details do not constitute any part of an offer or contract. In issuing them we do not have any authority to give any warranty or representation whatsoever in respect of this property. These details are provided without any responsibility on our part or the part of the vendors. No statements in these details are to be relied upon as representations of fact and purchasers should satisfy themselves by inspection or otherwise as to the accuracy of the statements contained therein.

Equipment: We have not tested the equipment or central heating system mentioned in these particulars and purchasers are advised to satisfy themselves as to their working order and condition.

Measurements: Great care is taken when measuring but measurements should not be relied upon for ordering carpets, equipment, etc.