



32 Primrose Road Hersham Surrey KT12 5JD

£1570pcm + Initial deposit



PRIMROSE ROAD KT12

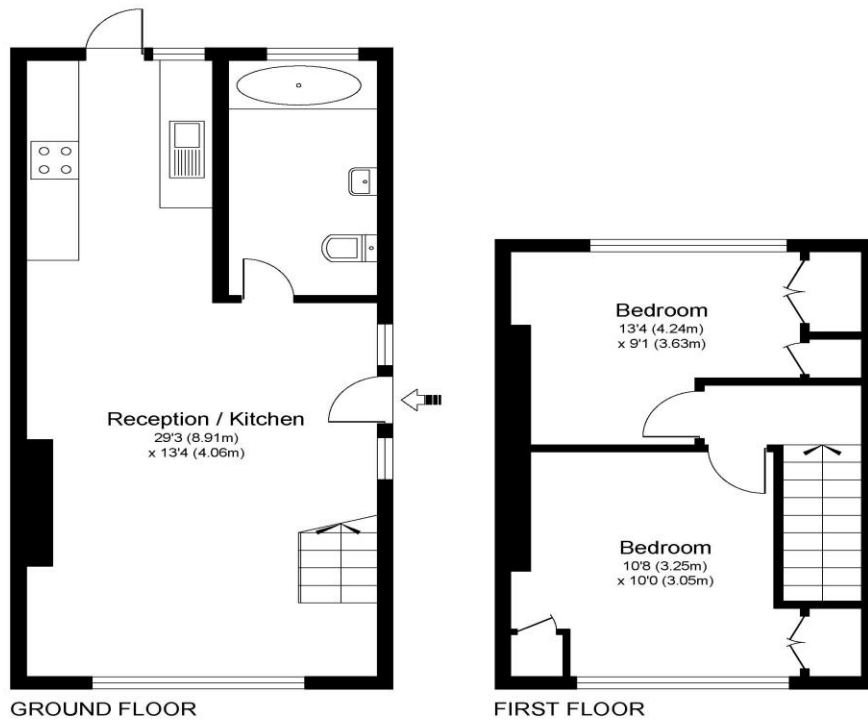

Approximate Gross Internal Floor Area: 58 m sq / 629 sq ft

Whilst every attempt has been made to ensure the accuracy of the floor plan contained here, measurements of doors, windows and rooms are approximate and no responsibility is taken for any error, omission or misstatements. These plans are not to scale and are for representation purposes only as defined by RICS Code of Measuring Practice and should be used as such by any prospective purchaser. Specifically no guarantee is given on total square footage of the property if quoted on this plan. Any figure given is for initial guidance only and should not be relied on as a basis of valuation.

A two-bedroom semi-detached house ideally located within Hersham Village. Well-presented throughout with a modern downstairs bathroom. The house also benefits from double glazing and gas central heating. There is a private rear garden with shed giving great outdoor space. Hersham Village is a lovely spot and has plenty of amenities such as a Waitrose and Costa Coffee. Walton-on-Thames mainline station is 0.7miles approx. and offers a fast train service into London Waterloo. Available 16th April 2025, unfurnished.

EPC Rating D.



AGENTS NOTES: These details do not constitute any part of an offer or contract. In issuing them we do not have any authority to give any warranty or representation whatsoever in respect of this property. These details are provided without any responsibility on our part or the part of the vendors. No statements in these details are to be relied upon as representations of fact and purchasers should satisfy themselves by inspection or otherwise as to the accuracy of the statements contained therein.

Equipment: We have not tested the equipment or central heating system mentioned in these particulars and purchasers are advised to satisfy themselves as to their working order and condition.

Measurements: Great care is taken when measuring but measurements should not be relied upon for ordering carpets, equipment, etc.