

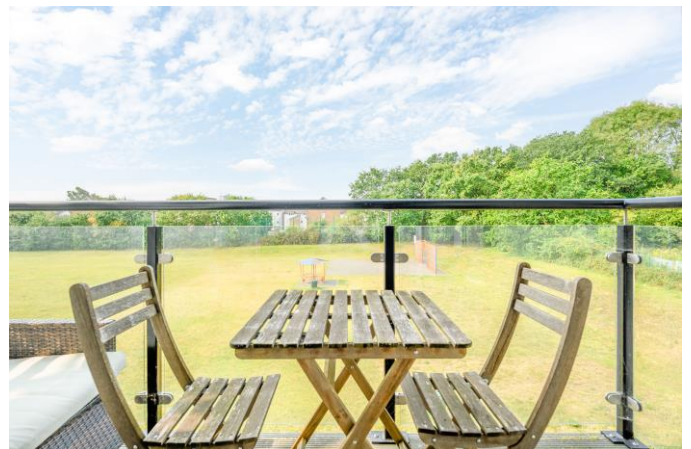

**8 Earhart Apartments Hawker Drive Addlestone Surrey KT15 2GW**

**£1395pcm + Initial deposit**



EARHART APARTMENTS, HAWKER DRIVE, ADDLESTONE, KT15

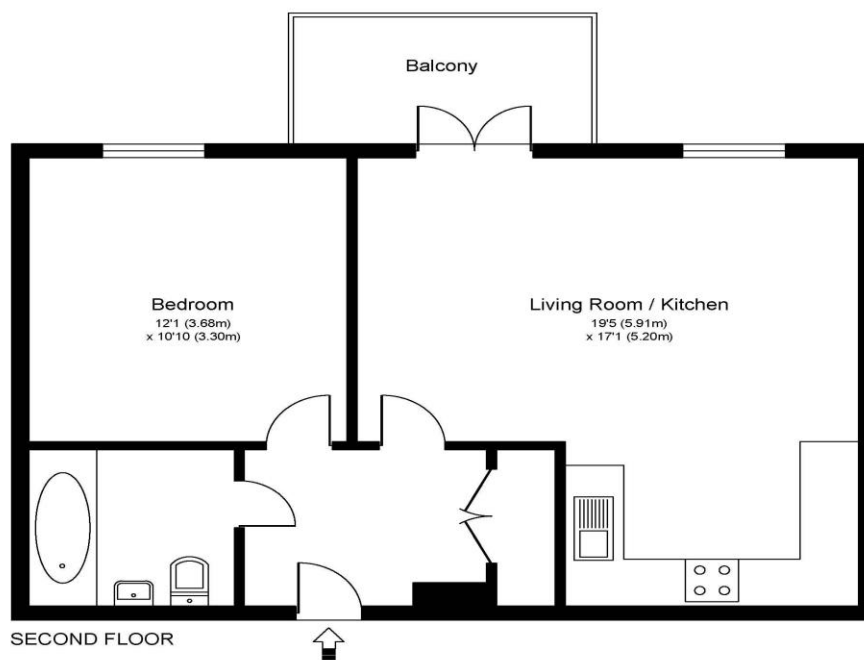

Approximate Gross Internal Floor Area: 50 m sq / 540 sq ft

Whilst every attempt has been made to ensure the accuracy of the floor plan contained here, measurements of doors, windows and rooms are approximate and no responsibility is taken for any error, omission or misstatements. These plans are not to scale and are for representation purposes only as defined by RICS Code of Measuring Practice and should be used as such by any prospective purchaser. Specifically no guarantee is given on total square footage of the property if quoted on this plan. Any figure given is for initial guidance only and should not be relied on as a basis of valuation.

A one-bedroom upper floor apartment set in this modern block close to local amenities in Addlestone centre. Also benefiting from one allocated parking space and private balcony with pleasant view. Internally this is a lovely home, everything is well presented and in good order throughout. The bedroom is a good double room, and the living space feels comfortable with the kitchen offset. There is additional hallway space and storage. From the living room you can access your private balcony giving usable outdoor space with a nice, pleasant outlook across local parks and green land. Externally you have an allocated parking space within the resident's car park. Located within the centre of Addlestone not far from the shops and Town centre amenities including the popular Light Cinema, Tesco and Costa Coffee. Addlestone train station is just up the road. There are also good road links from this end of town with Junction 11 of the M25 close by. Available from the end of October 2024, we are flexible on furniture this time around subject to needs. EPC Rating B.



**AGENTS NOTES:** These details do not constitute any part of an offer or contract. In issuing them we do not have any authority to give any warranty or representation whatsoever in respect of this property. These details are provided without any responsibility on our part or the part of the vendors. No statements in these details are to be relied upon as representations of fact and purchasers should satisfy themselves by inspection or otherwise as to the accuracy of the statements contained therein.

**Equipment:** We have not tested the equipment or central heating system mentioned in these particulars and purchasers are advised to satisfy themselves as to their working order and condition.

**Measurements:** Great care is taken when measuring but measurements should not be relied upon for ordering carpets, equipment, etc.