



310 The Heart Walton-On-Thames Surrey KT12 1GD

£1450pcm + Initial deposit



APPROXIMATE GROSS INTERNAL FLOOR AREA 594 sq. ft. 55 m sq.

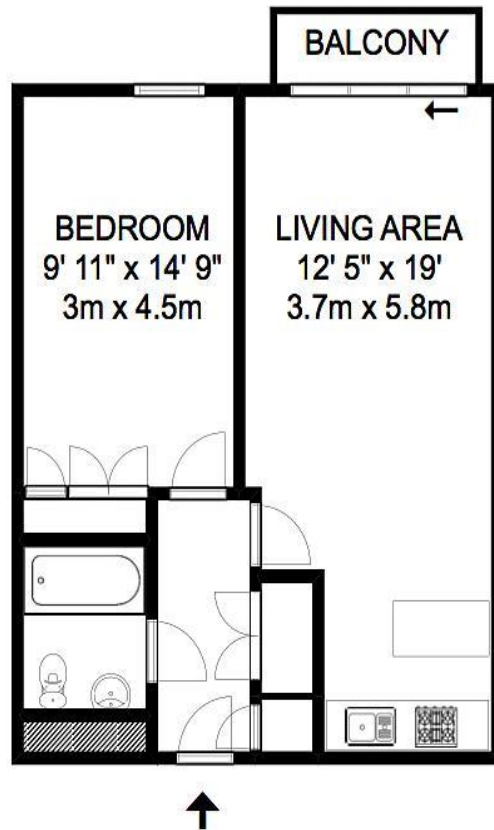

Whilst every attempt has been made to ensure the accuracy of the floor plan contained here, measurements are approximate and no responsibility is taken for any error, omission, or mis-statement. The plan is for illustrative purposes only and should be used as such by any prospective purchaser.

A superb one bedroom, third floor apartment located in this popular modern development in Walton-on-Thames. The property benefits from concierge service, 24 hour security and underground parking. There are also built-in wardrobes in the bedroom, a south-facing lounge with balcony and an open-plan kitchen with fitted appliances. Available from 24TH August 2024, unfurnished. EPC Rating B.



AGENTS NOTES: These details do not constitute any part of an offer or contract. In issuing them we do not have any authority to give any warranty or representation whatsoever in respect of this property. These details are provided without any responsibility on our part or the part of the vendors. No statements in these details are to be relied upon as representations of fact and purchasers should satisfy themselves by inspection or otherwise as to the accuracy of the statements contained therein.

Equipment: We have not tested the equipment or central heating system mentioned in these particulars and purchasers are advised to satisfy themselves as to their working order and condition.

Measurements: Great care is taken when measuring but measurements should not be relied upon for ordering carpets, equipment, etc.