

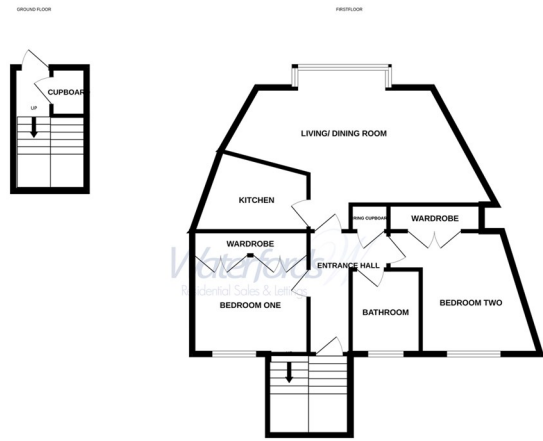

Bernard Court | Vale Road | Ca | GU15 3AY

£1,300 PCM

**Waterfords** *W*  
Residential Sales & Lettings



Waterford's Residential Sales & Lettings

Energy Efficiency Rating		
	Current	Potential
Very energy efficient - lower running costs		
(92 plus) A		
(81-91) B		
(69-80) C		
(55-68) D		
(39-54) E		
(21-38) F		
(1-20) G		
Not energy efficient - higher running costs		
England & Wales	EU Directive 2002/91/EC	

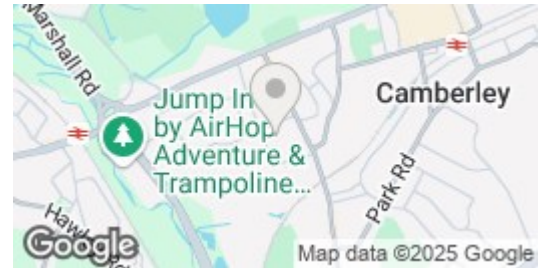

## Description

This spacious two bedroom first floor apartment is located within easy reach of Camberley town and other local amenities. Internally the apartment comprises large reception room, kitchen with appliances, two double bedrooms with built in storage and a family bathroom.

## Key features

- Large Living Room
- Private Entrance
- Available July 19th 2025
- EPC - C
- Minimum Term 6 Month Let
- Large Two Double Bedrooms
- Walking Distance To Camberley Town
- Unfurnished
- Council Tax Band c



35 Plough Road  
Hampshire  
GU46 7UW  
01276 903006

surreylettings@waterfords.co.uk  
<https://www.waterfords.co.uk/>