

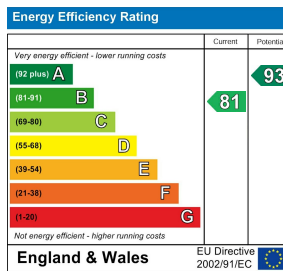

Nym Close | | Camberley | GU15 3HG

£1,850 PCM

Waterfords W
Residential Sales & Lettings

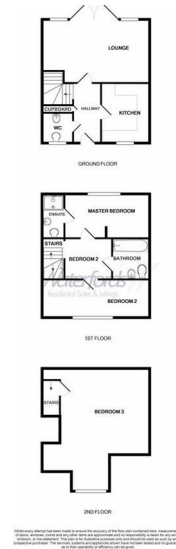

Description

Spacious Three-Bedroom End of Terrace Home – Nym Close, Camberley – Available from 28th May 2025 – Unfurnished

Introducing this well-presented and generously proportioned three-bedroom end of terrace property, ideally located in the sought-after residential area of Nym Close, Camberley. This fantastic home offers spacious living accommodation, a private rear garden, and off-street parking, making it a perfect choice for families, professionals, or sharers seeking comfort, convenience, and a quiet neighbourhood.

Key features

- Private Rear Garden
- En-Suite To Master
- Allocated parking
- Near to local amenities
- EPC B
- Three Double Bedrooms
- Further Family Bathroom
- Available 28th April 2025 On An Unfurnished Basis
- Minimum 12 Month Let



35 Plough Road
Hampshire
GU46 7UW
01276 903006

surreylettings@waterfords.co.uk
<https://www.waterfords.co.uk/>