



Flat 3

Nym Close | | Camberley | GU15 3HG

£1,150 PCM

Waterfords 
Residential Sales & Lettings

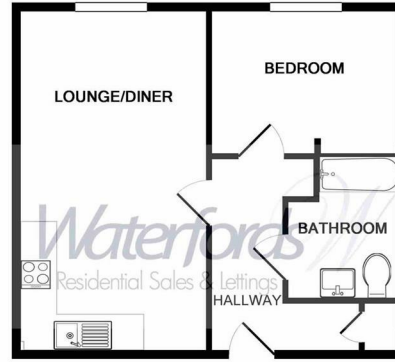

TOTAL APPROX. FLOOR AREA 404 SQ.FT. (37.5 SQ.M.)

Whilst every attempt has been made to ensure the accuracy of the floor plan contained here, measurements of doors, windows, rooms and any other items are approximate and no responsibility is taken for any error, omission, or mis-statement. This plan is for illustrative purposes only and should be used as such by any prospective purchaser. The services, systems and appliances shown have not been tested and no guarantee as to their operability or efficiency can be given
Made with Metropix ©2017



Energy Efficiency Rating		Current	Potential
Very energy efficient - lower running costs			
(92 plus) A			
(81-91) B		81	81
(69-80) C			
(55-68) D			
(39-54) E			
(21-38) F			
(1-20) G			
Not energy efficient - higher running costs			
England & Wales	EU Directive 2002/91/EC		

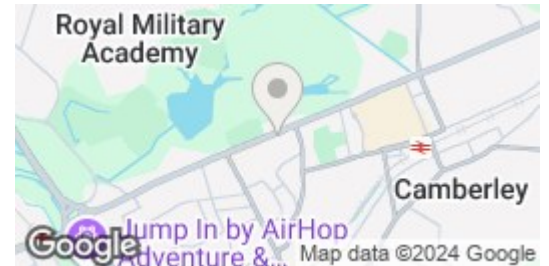

Description

A well presented luxury first floor apartment located within walking distance to Camberley town center. Accommodation comprises open plan modern kitchen/living room, well proportioned double bedroom with built in wardrobe and modern bathroom. Available November 4th 2024

Key features

- First Floor Apartment
- Modern Kitchen With Appliances
- Allocated Parking
- Council Tax Band C
- Minimum 12 Month Let
- One Double Bedroom
- Modern Bathroom
- Available 4th November on an unfurnished basis
- EPC Band B



35 Plough Road
Hampshire
GU46 7UW
01276 903006

surreylettings@waterfords.co.uk
<https://www.waterfords.co.uk/>