

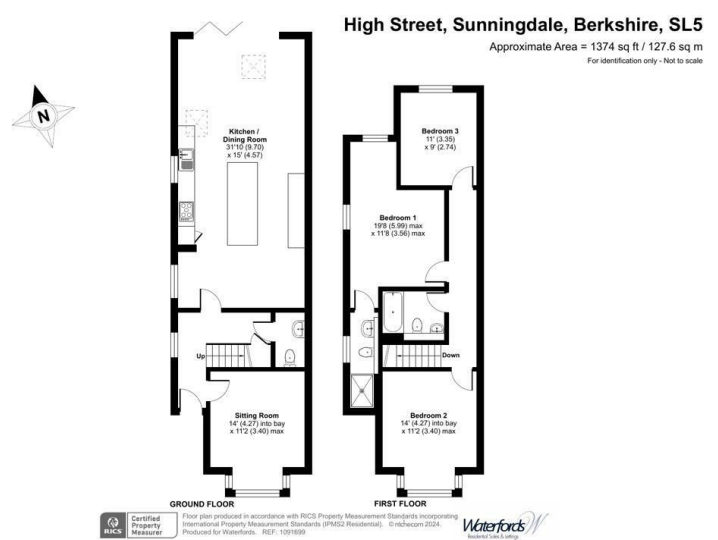

High Street | Sunningdale | Berkshire | SL5 0NG

£3,500

Waterfords 
Residential Sales & Lettings



Energy Efficiency Rating		Current	Potential
<i>Very energy efficient - lower running costs</i>			
(92 plus)	A		
(81-91)	B		
(69-80)	C		
(55-68)	D		
(39-54)	E		
(21-38)	F		
(1-20)	G		
<i>Not energy efficient - higher running costs</i>			
England & Wales		76	86
EU Directive 2002/91/EC			



Description

Welcome to this stunning three-bedroom semi-detached house located on the prestigious High Street in Sunningdale, Berkshire. This property boasts two reception rooms, perfect for entertaining guests or simply relaxing with your family. With two bathrooms, there will be no more queuing in the morning rush.

The high specification of this house is evident throughout, offering a contemporary feel that is both stylish and comfortable. The location on Sunningdale Village High Street provides convenience and a vibrant atmosphere, with local amenities just a stone's throw away.

Whether you're looking for a new family home or a place to settle down, this property offers the perfect blend of modern living in a sought-after area. Don't miss the opportunity to make this house your home sweet home in beautiful Berkshire.

Key features

- Semi detached Victorian house
- Three bedrooms
- Further reception room
- Gas fired central heating system
- Council Tax Band TBC
- Fully modernised
- Contemporary open plan living / dining and kitchen space.
- Family bathroom and en suite to master bedroom
- Village location
- Available Now



35 Plough Road
 Hampshire
 GU46 7UW
 01276 903006
 surreylettings@waterfords.co.uk
<https://www.waterfords.co.uk/>