

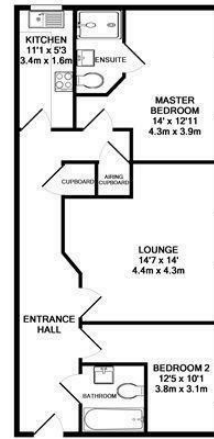

Stickledown | Deepcut | Camberley | GU16 6GB

£1,200 PCM

*Waterfords* W  
Residential Sales & Lettings



TOTAL APPROX. FLOOR AREA 65.2 SQ.M. (702 SQ.FT.)  
 Whilst every attempt has been made to ensure the accuracy of the floor plan contained here, measurements of doors, windows, rooms and any other items are approximate and no responsibility is taken for any error, omission, or misstatement. This plan is for illustrative purposes only and should be used as such by any prospective purchaser. The services, systems and appliances shown have not been tested and no guarantee as to their capability or efficiency can be given. Made with Metropix i2015

Energy Efficiency Rating		Current	Potential
Very energy efficient - lower running costs			
(92 plus)	A		
(81-91)	B	84	86
(69-80)	C		
(55-68)	D		
(39-54)	E		
(21-38)	F		
(1-20)	G		
Not energy efficient - higher running costs			
England & Wales		EU Directive 2002/91/EC	



## Description

Welcome to this charming two-bedroom, two-bathroom apartment located in the sought-after area of Stickledown, Camberley. Situated in the popular Dettingen Crescent, this spacious flat offers a comfortable and convenient living space.

## Key features

- Two Bedroom Apartment
- Large Living Room
- Unfurnished
- En-suite to Master and Further Family Bathroom
- Allocated Parking
- Available 7th April 2020



35 Plough Road  
 Hampshire  
 GU46 7UW  
 01276 903006

surreylettings@waterfords.co.uk  
<https://www.waterfords.co.uk/>