



## 5 Manor House

London Road | Blackwater | Camberley | GU17 0AA

£1,150 PCM

*Waterfords* W  
Residential Sales & Lettings



GROUND FLOOR

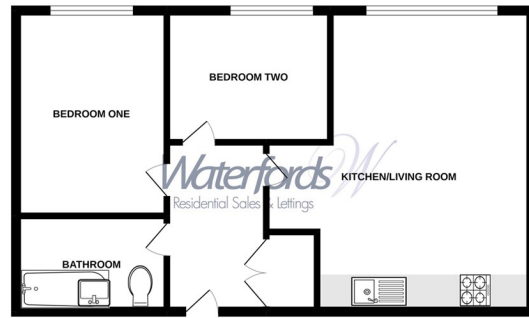

Energy ratings have been made to ensure the accuracy of the Energy Performance Certificate. Measurements of energy, carbon, water and any other items are approximate and no responsibility is taken for any errors, omissions or misstatements. This page is for illustrative purposes only and should not be used as a basis for any prospective purchase. The current, specific and detailed details have been reviewed and no guarantee is made with respect to the accuracy of the information provided.

Energy Efficiency Rating		Current	Potential
Very energy efficient - lower running costs			
(92 plus)	A		
(81-91)	B		
(69-80)	C		
(55-68)	D	63	63
(39-54)	E		
(21-38)	F		
(1-20)	G		
Not energy efficient - higher running costs			
England & Wales		EU Directive 2002/91/EC	

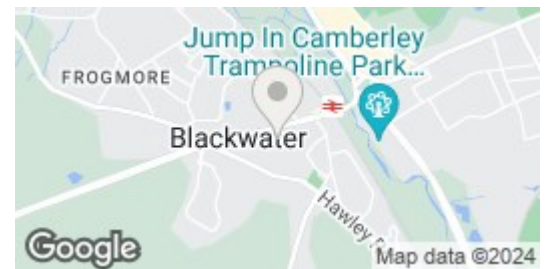

## Description

Presenting this spacious two bedroom apartment located very close to local amenities and just walking distance to Blackwater train station. The property is available end of May on a unfurnished basis.

## Key features

- Two Bedroom Apartment
- Allocated Parking
- Well Proportioned Accommodation
- Council Tax Band: B
- Modern Finish Throughout
- Unfurnished
- Available End Of May
- EPC: D



35 Plough Road  
Hampshire  
GU46 7UW  
01276 903006

surreylettings@waterfords.co.uk  
<https://www.waterfords.co.uk/>