



Fleet Road | Fleet | Hampshire | GU51 4PA

£1,250 PCM

Waterfords
Residential Sales & Lettings



GROUND FLOOR
532 sq.ft. (49.5 sq.m.) approx.

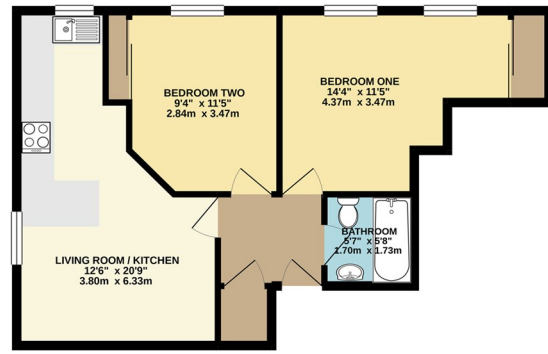

TOTAL FLOOR AREA: 532 sq.ft. (49.5 sq.m.) approx.
While every effort has been made to ensure the accuracy of the information contained here, Waterfords does not accept any liability for any errors or omissions. The plan is for illustrative purposes only and should not be used as a basis for any prospective purchase. The services, facilities and equipment shown have not been tested and no guarantee as to their operation or efficiency can be given.
Waterfords (2025)

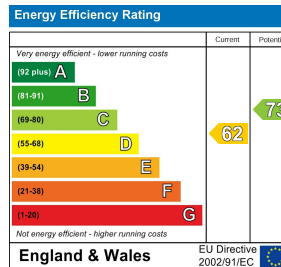

Description

Modern apartment boasting two bedrooms, open plan living room kitchen and a family bathroom, offered to highest of standards. Set in the town centre of Fleet walking distance to Fleet train line and local amenities. Available in August 2025 Unfurnished, please note no parking comes with the property additional parking can be obtained with permits in the local area.

Key features

- Modern Finish
- Parking Can Be Obtained By Permits
- Unfurnished
- Minimum Term 6 Month Let
- EPC B
- Two Bedrooms
- Town Centre Location
- Available August 2025
- Council Tax Band C



39 The Hart Centre
Fleet
Hampshire
GU51 3LA
01252 623330
hampshirelettings@waterfords.co.uk
<https://www.waterfords.co.uk/>