



Branksomewood Road | | Fleet | GU51 4SW

£1,600

*Waterfords* W  
Residential Sales & Lettings



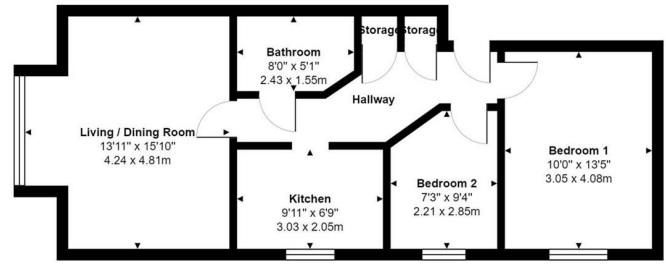

Total Area: 614 ft² ... 57.1 m²

Branksome Walk Manor, Branksomewood Road, Fleet, GU51 4SW

All measurements are approximate and for display purposes only



Energy Efficiency Rating		
	Current	Potential
Very energy efficient - lower running costs		
(92 plus) A		
(81-91) B		
(69-80) C		
(55-68) D		
(39-54) E		
(21-38) F		
(1-20) G		
Not energy efficient - higher running costs		
England & Wales	EU Directive 2002/91/EC	

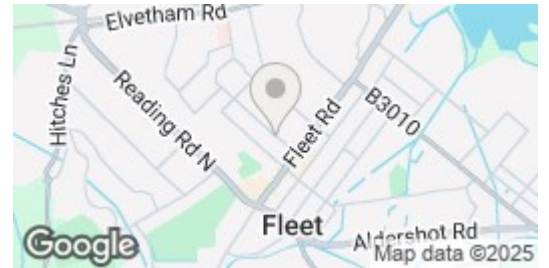

## Description

A beautifully refurbished two-bedroom apartment situated in the sought-after Branksome Walk Manor, exclusively for residents aged 55 and over. Located in the heart of Fleet Town Centre, this luxury property offers modern, comfortable living within easy reach of local shops, amenities, and transport links.

## Key features

- Luxury Refurbished Apartment
- Two Bedrooms
- Allocated Parking
- Communal Gardens
- Council Tax Band D
- Over 55's Only
- High Specification
- Town Centre Location
- Internal Lift
- EPC B - Minimum 12 Month Let



39 The Hart Centre  
Fleet  
Hampshire  
GU51 3LA  
01252 623330

[hampshirelettings@waterfords.co.uk](mailto:hampshirelettings@waterfords.co.uk)  
<https://www.waterfords.co.uk/>