



Fleet House | Barley Way | Ancells Farm | GU51 2AB

£1,025 PCM

*Waterfords*   
Residential Sales & Lettings



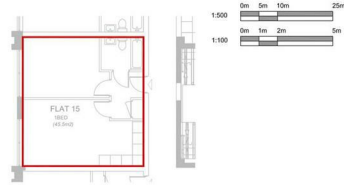

Plan  
1/100 @ A4



Ground floor  
1/500 @ A4

Flat 15  
Fleet House  
Barley Way  
Fleet  
Hampshire  
GU51 2QT

Energy Efficiency Rating		Current	Potential
Very energy efficient - lower running costs			
(92 plus)	A		
(81-91)	B		
(69-80)	C		
(55-68)	D		
(39-54)	E		
(21-38)	F		
(1-20)	G		
Not energy efficient - higher running costs			
England & Wales		EU Directive 2002/91/EC	



## Description

Waterfords are proud to present this modern one bedroom apartment available on an unfurnished basis from 8th August 2024. Disclaimer: All photos are a visual representation of the finished apartments. Whilst the particulars and information provided have been prepared with due care, this is designed to give a general idea of the development, please get in touch to book your personal viewing.

## Key features

- Modern Apartments
- Walking Distance to Fleet Train Station
- spacious Open Plan Living
- Unfurnished
- One Bedroom
- Exceedingly High Standard
- Available 8th August 2024



39 The Hart Centre  
Fleet  
Hampshire  
GU51 3LA  
01252 623330

[hampshirelettings@waterfords.co.uk](mailto:hampshirelettings@waterfords.co.uk)  
<https://www.waterfords.co.uk/>