



65 School Road
Buxton



Part of the Bagshaws Partnership

Estate Agents. Valuers. Auctioneers. Chartered Surveyors
Part of the Bagshaws Partnership

65 School Road

Buxton
SK17 8AR



3



1



2



D

Offers In The Region Of
£199,950

Entrance Porch

Upvc front door and inner door leading to:

Hallway

With stairs off to the first floor. Radiator.

Lounge

Upvc window to front. Radiator

Dining Room

Upvc window to rear. Radiator. Original storage cupboards. Large pantry cupboard with window to side.

Kitchen

Base units with worktop over incorporating sink. Space for cooker. Upvc window to rear.

Side Porch

Upvc doors to front and rear.

First Floor Landing

Upvc window to side. Loft access.

Bedroom

Upvc window to rear. Radiator

Bedroom

Bedroom

Upvc window to front. Radiator



Buxton - 0129827524



buxtonhomes@buryandhilton.co.uk





Energy Efficiency Rating		
	Current	Potential
Very energy efficient - lower running costs		
(92 plus) A		
(81-91) B		
(69-80) C		
(55-68) D		
(39-54) E		
(21-38) F		
(1-20) G		
Not energy efficient - higher running costs		
England & Wales	63	73
EU Directive 2002/91/EC		

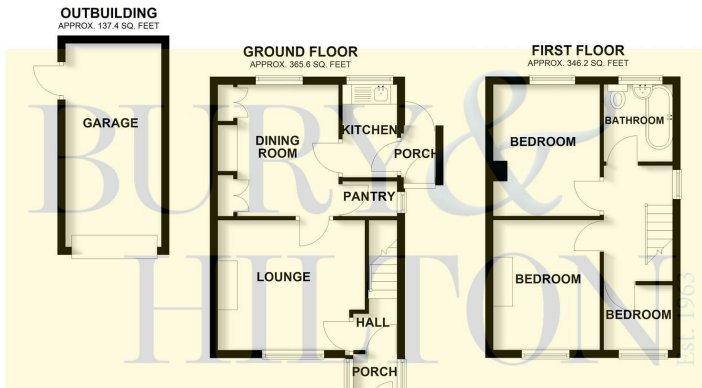

TOTAL AREA: APPROX. 849.2 SQ. FEET

Plan produced by www.firstproperties.co.uk. We accept no responsibility for any mistake or inaccuracy contained within the floorplan. The floorplan is provided as a guide and should be taken as an illustration only. The measurements, contents and positioning are approximations only and provided as a guide only and not an exact replication of the property.

Plan produced using PlanUp.

Accommodation

Bathroom

Upvc window to front. Radiator

Outside

To the front of the property is a driveway with access to the garage. Steps leading to front and side doors. To the rear of the property is a large garden.

Garage

With roller door to front and door to side.

FREEHOLD

HPBC- BAND B

EPC- D

Agents Notes

Bury & Hilton have made every reasonable effort to ensure these details offer an accurate and fair description of the property. The particulars are produced in good faith, for guidance only and do not constitute or form an offer or part of the contract for sale. Bury & Hilton and their employees are not authorised to give any warranties or representations in relation to the sale and give notice that all plans, measurements, distances, areas and any other details referred to are approximate and based on information available at the time of printing.

Fixtures and Fittings

Only those fixtures and fittings referred to in the sale particulars are included in the purchase price. Bury & Hilton have not tested any equipment, fixtures, fittings or services and no guarantee is given that they are in good working order.

Broadband Connectivity

It is understood that the property benefits from a satisfactory broadband service; however, due to the property's location, connection speeds may fluctuate. We recommend that prospective purchasers consult <https://www.ofcom.org.uk> to obtain an estimated broadband speed for the area.

Mobile Network Coverage

The property is well-situated for mobile signal coverage and is expected to be served by a broad range of providers. Prospective purchasers are encouraged to consult the Ofcom website (<https://www.ofcom.org.uk>) to obtain an estimate of the signal strength for this specific location.

Agents Notes

Bury & Hilton have made every reasonable effort to ensure these details offer an accurate and fair description of the property. The particulars are produced in good faith, for guidance only and do not constitute or form an offer or part of the contract for sale. Bury & Hilton and their employees are not authorised to give any warranties or representations in relation to the sale and give notice that all plans, measurements, distances, areas and any other details referred to are approximate and based on information available at the time of printing.



Part of the Bagshaws Partnership

17 High Street, Buxton, Derbyshire, SK17 6ET

T: 0129827524

E: buxtonhomes@buryandhilton.co.uk

www.buryandhilton.co.uk

Part of the Bagshaws Partnership



Land · Property · Livestock

Offices in:

Ashbourne	01335 342201
Bakewell	01629 812777
Buxton	01298 27524
Leek	01538 383344
Uttoxeter	01889 562811

arla | propertymark

