



20 Mack Grove

, Bootle, L30 2NU

Offers over £130,000



Welcome to this charming semi-detached house located in the highly sought-after area of Mack Grove, Bootle. This property boasts a superb presentation throughout, offering a perfect blend of comfort and style.

Upon entering, you are greeted by a cosy reception room, ideal for relaxing or entertaining guests. The house features two lovely bedrooms, providing ample space for a small family or guests. The bathroom is well-maintained and offers convenience for daily use.

One of the standout features of this property is the beautifully landscaped rear garden, perfect for enjoying a cup of tea on a sunny afternoon or hosting a barbecue with friends and family. Additionally, the off-road parking adds a touch of convenience for those with vehicles.

Situated in the L30 location, this home benefits from excellent local schools, making it an ideal choice for families with children. Whether you're looking for a peaceful retreat or a place to create lasting memories, this property offers the perfect setting to call home. Don't miss out on the opportunity to make this charming house your own.



Area Map

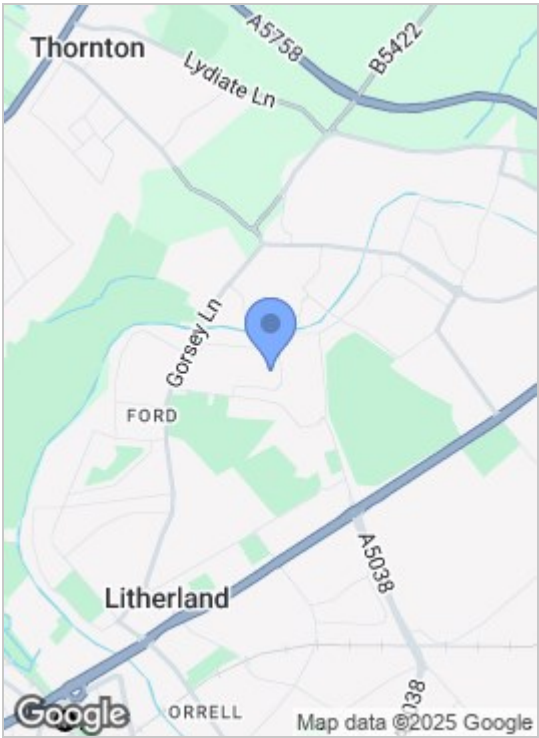

Floor Plans

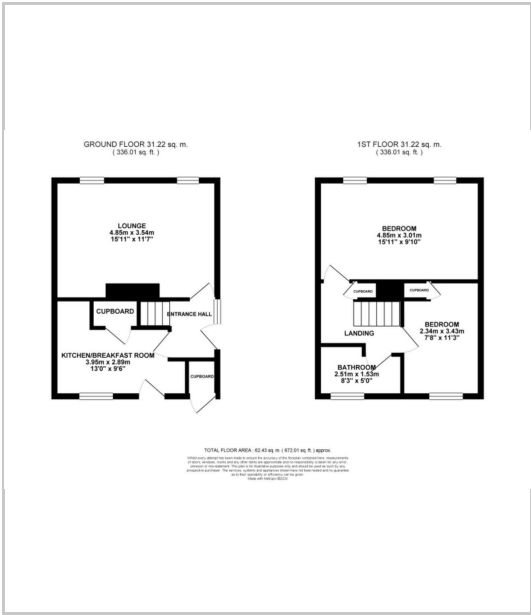

Energy Efficiency Graph

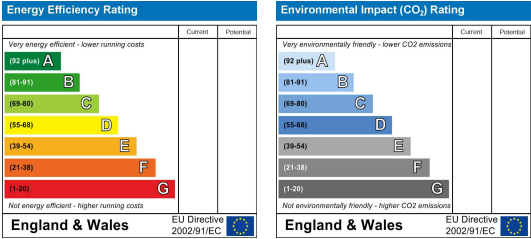

These particulars, whilst believed to be accurate are set out as a general outline only for guidance and do not constitute any part of an offer or contract. Intending purchasers should not rely on them as statements of representation of fact, but must satisfy themselves by inspection or otherwise as to their accuracy. No person in this firms employment has the authority to make or give any representation or warranty in respect of the property.

82 Coronation Road, Crosby, Liverpool L23 5RH

Tel: 0151 909 3003
Email: crosby@abode-group.co.uk
Web: www.abode-group.co.uk

6 Allerton Road, Mossley Hill, Liverpool, L18 1LN

Tel: 0151 601 3003
Email: allerton@abode-group.co.uk
Web: www.abode-group.co.uk

2 Chapel Lane, Formby, Liverpool, L37 4DU

Tel: 01704 827 402
Email: formby@abode-group.co.uk
Web: www.abode-group.co.uk