



## 60 Melrose Road

Kirkdale, Liverpool, L4 1UJ

**Offers in the region of £130,000**

 3  1  2  D



# 60 Melrose Road

Kirkdale, Liverpool, L4 1UJ

## Offers in the region of £130,000



GROUND FLOOR

1ST FLOOR

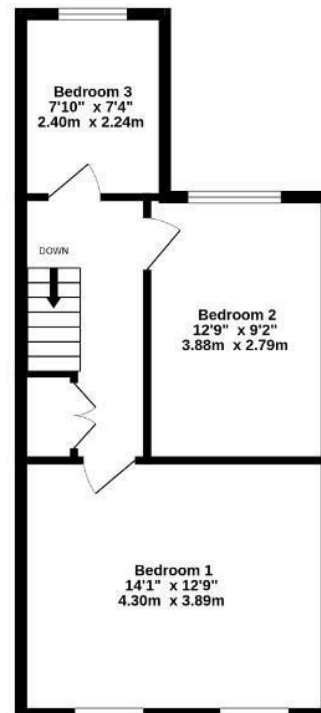
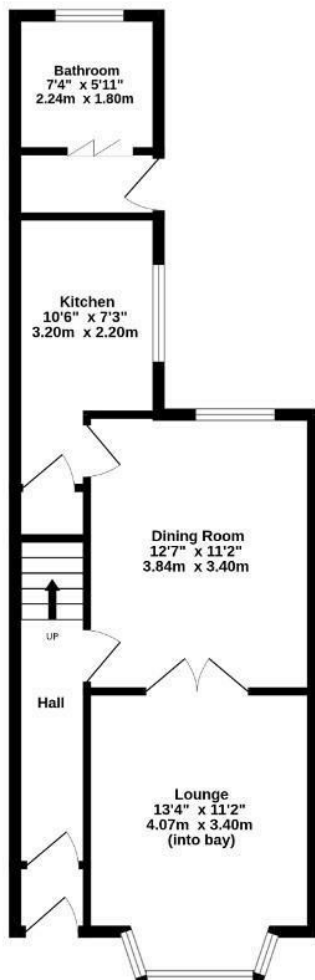

MELROSE ROAD, LIVERPOOL

While every attempt is made to ensure the accuracy of this floorplan, measurements are approximate only and no responsibility is accepted by Metroplex ©2023 in relation to any error, omission or mis-statement. The plan is for illustrative purposes only and should be used as such by any prospective purchaser. Made with Metroplex ©2024



## Road Map

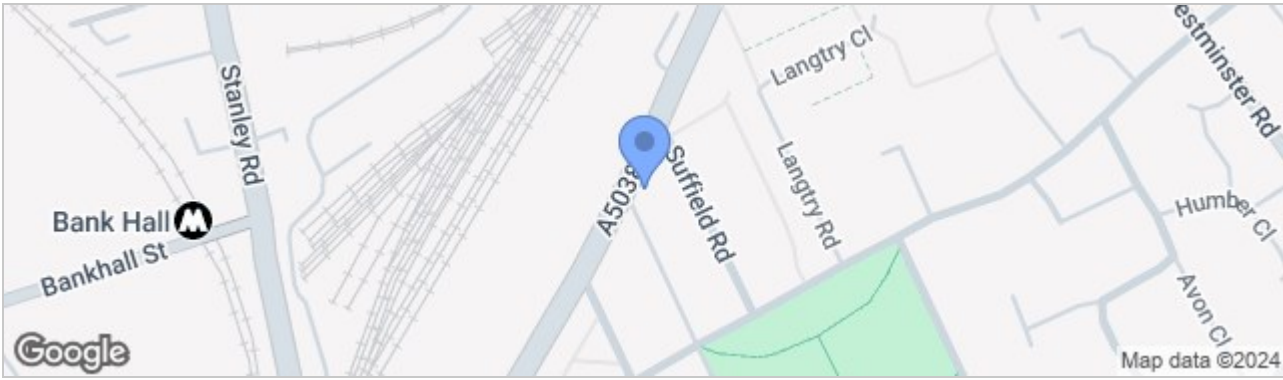

## Hybrid Map



## Terrain Map

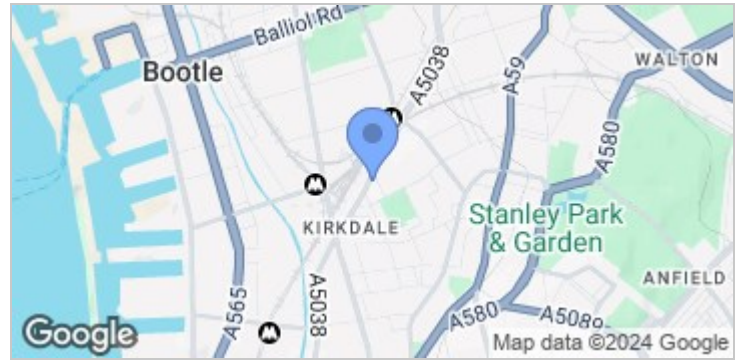

- **EXTENDED THREE BEDROOM MID TERRACE**
- **TWO RECEPTION ROOMS WITH DIVIDING DOUBLE DOORS**
- **DOWNSTAIRS BATHROOM AND WC**
- **ACCESS TO REAR YARD**
- **FANTASTIC LOCATION**
- **DOUBLE GLAZED WINDOWS AND GAS CENTRAL HEATING**
- **IDEAL FOR FIRST TIME BUYERS AND INVESTORS**
- **FREEHOLD**

## Viewing

Please contact our Crosby Office on 01519093003 if you wish to arrange a viewing appointment for this property or require further information.

These particulars, whilst believed to be accurate are set out as a general outline only for guidance and do not constitute any part of an offer or contract. Intending purchasers should not rely on them as statements of representation of fact, but must satisfy themselves by inspection or otherwise as to their accuracy. No person in this firm's employment has the authority to make or give any representation or warranty in respect of the property.

## Energy Efficiency Graph

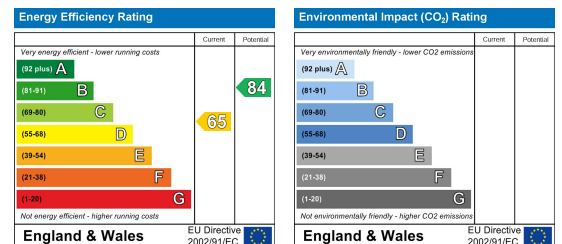

82 Coronation Road, Crosby, Liverpool L23 5RH

6 Allerton Road, Mossley Hill, Liverpool, L18 1LN

2 Chapel Lane, Formby, Liverpool, L37 4DU

Tel: 0151 909 3003  
Email: crosby@abode.group.co.uk  
Web: www.abode-group.co.uk

Tel: 0151 601 3003  
Email: allerton@abode-group.co.uk  
Web: www.abode-group.co.uk

Tel: 01704 827 402  
Email: formby@abode-group.co.uk  
Web: www.abode-group.co.uk