



## 38 Whitham Avenue

, Liverpool, L23 0RD

**£325,000**



Welcome to Whitham Avenue, Crosby - a charming semi-detached Victorian family house that offers the perfect blend of comfort and style. This delightful property boasts four bedrooms and two bathrooms, making it an ideal choice for a growing family.

Upon entering, you are greeted by three spacious reception rooms that provide ample space for entertaining guests or simply relaxing with your loved ones. The layout of the house is thoughtfully designed to cater to the needs of modern family living.

One of the standout features of this property is its beautifully landscaped rear garden. Imagine enjoying a cup of tea in the morning or hosting a barbecue in the evenings in this serene outdoor space. Additionally, the off-road parking to the rear of the property ensures convenience and peace of mind for you and your family.

Located in an area known for its excellent local schools, this house is perfect for families with children who value education. The convenience of having schools nearby adds to the appeal of this already charming home.



## Area Map



## Floor Plans

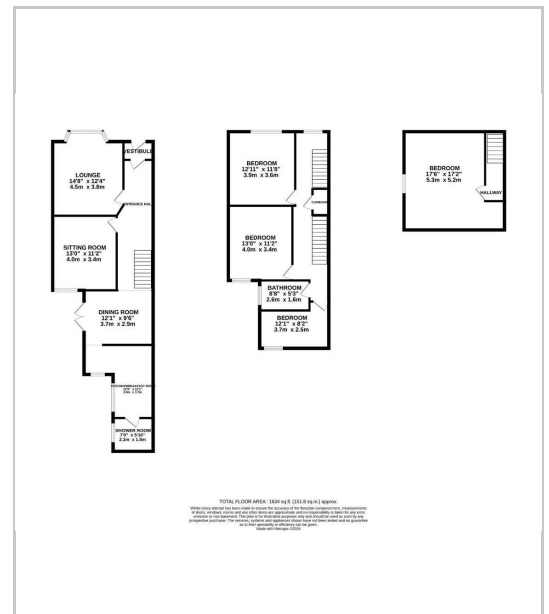

## Energy Efficiency Graph

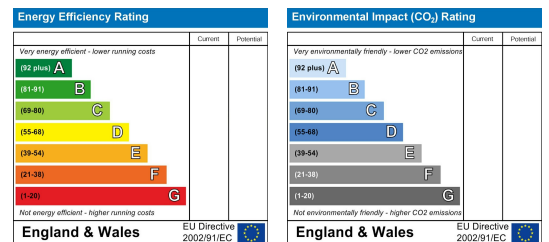

These particulars, whilst believed to be accurate are set out as a general outline only for guidance and do not constitute any part of an offer or contract. Intending purchasers should not rely on them as statements of representation of fact, but must satisfy themselves by inspection or otherwise as to their accuracy. No person in this firm's employment has the authority to make or give any representation or warranty in respect of the property.

82 Coronation Road, Crosby, Liverpool L23 5RH

6 Allerton Road, Mossley Hill, Liverpool, L18 1LN

2 Chapel Lane, Formby, Liverpool, L37 4DU

Tel: 0151 909 3003

Email: crosby@abode.group.co.uk

Web: www.abode-group.co.uk

Tel: 0151 601 3003

Email: allerton@abode-group.co.uk

Web: www.abode-group.co.uk

Tel: 01704 827 402

Email: formby@abode-group.co.uk

Web: www.abode-group.co.uk