



## 44 St. Anthony's Road

Blundellsands, Liverpool, L23 8TR

**£835,000**



Welcome to this exquisite property located on St. Anthony's Road in the prestigious Blundellsands area of Liverpool. This stunning detached house boasts 4 reception rooms, 5 bedrooms, and 3 bathrooms, providing ample space for comfortable living.

One of the standout features of this property is its large south-facing rear garden, perfect for enjoying the British sunshine in the privacy of your own home. Situated on a generous and secluded plot, this residence offers a peaceful retreat from the hustle and bustle of everyday life.

The location of this property is truly unbeatable, with a short walk to the picturesque Crosby Beach where you can enjoy leisurely strolls along the coastline. Additionally, the area is known for its excellent local schools, making it an ideal choice for families looking to settle down.

Don't miss out on the opportunity to own a piece of luxury in this sought-after neighbourhood. Contact us today to arrange a viewing and experience the charm and elegance of this magnificent property for yourself.





## Area Map



## Floor Plans

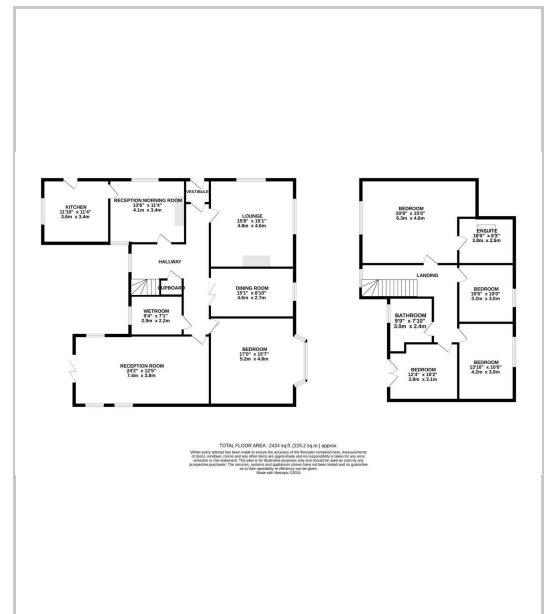

## Energy Efficiency Graph

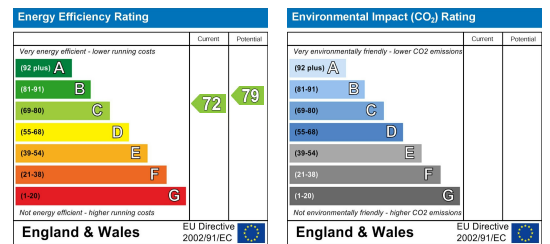

These particulars, whilst believed to be accurate are set out as a general outline only for guidance and do not constitute any part of an offer or contract. Intending purchasers should not rely on them as statements of representation of fact, but must satisfy themselves by inspection or otherwise as to their accuracy. No person in this firm's employment has the authority to make or give any representation or warranty in respect of the property.

82 Coronation Road, Crosby, Liverpool L23 5RH

6 Allerton Road, Mossley Hill, Liverpool, L18 1LN

2 Chapel Lane, Formby, Liverpool, L37 4DU

Tel: 0151 909 3003  
 Email: crosby@abode.group.co.uk  
 Web: www.abode-group.co.uk

Tel: 0151 601 3003  
 Email: allerton@abode-group.co.uk  
 Web: www.abode-group.co.uk

Tel: 01704 827 402  
 Email: formby@abode-group.co.uk  
 Web: www.abode-group.co.uk