



21 Willoughby Road

Waterloo, Liverpool, L22 0NP

Offers in the region of £250,000



Welcome to this charming property located on Willoughby Road in the heart of Waterloo, Liverpool. This delightful house boasts two reception rooms, perfect for entertaining guests or simply relaxing with your loved ones. With four bedrooms, there is ample space for a growing family or for those who enjoy having a home office or guest room.

The property features a modern NEW bathroom, ensuring that you can unwind in style after a long day. The open plan dining/lounge area is ideal for creating a warm and inviting space to enjoy meals together or to curl up with a good book.

One of the highlights of this property is the south-west facing yard, offering a sunny retreat where you can bask in the warmth of the sun or enjoy al fresco dining during the summer months. The fantastic location of this property means that you are just a stone's throw away from all the amenities that Waterloo has to offer including the beach and excellent schools.

Don't miss out on the opportunity to make this four-bedroom mid-terrace house your new home. Book a viewing today and discover the endless possibilities that this property has to offer.

Council Tax B
EPC B



Area Map

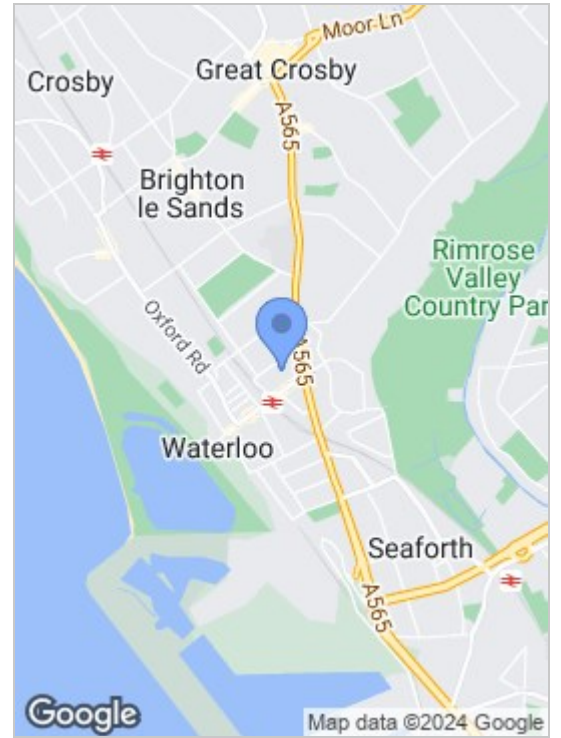

Floor Plans

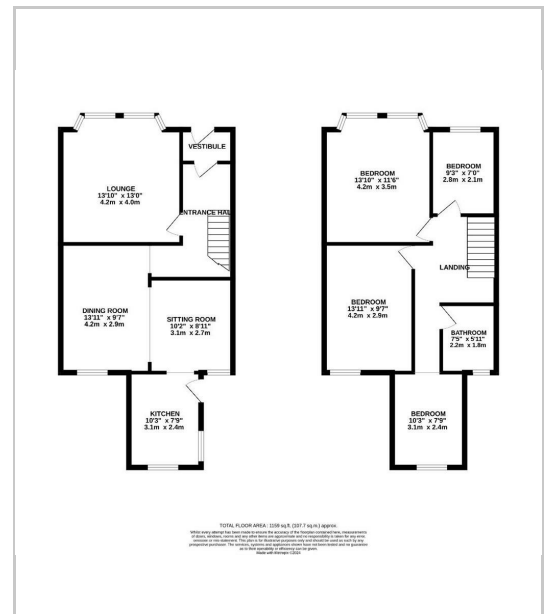

Energy Efficiency Graph

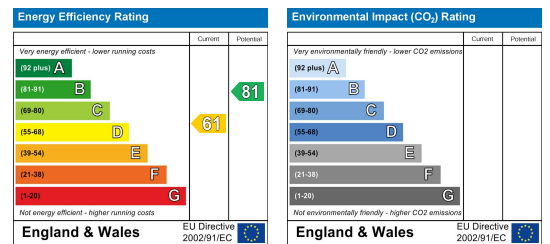

These particulars, whilst believed to be accurate are set out as a general outline only for guidance and do not constitute any part of an offer or contract. Intending purchasers should not rely on them as statements of representation of fact, but must satisfy themselves by inspection or otherwise as to their accuracy. No person in this firm's employment has the authority to make or give any representation or warranty in respect of the property.

82 Coronation Road, Crosby, Liverpool L23 5RH

6 Allerton Road, Mossley Hill, Liverpool, L18 1LN

2 Chapel Lane, Formby, Liverpool, L37 4DU

Tel: 0151 909 3003
 Email: crosby@abode.group.co.uk
 Web: www.abode-group.co.uk

Tel: 0151 601 3003
 Email: allerton@abode-group.co.uk
 Web: www.abode-group.co.uk

Tel: 01704 827 402
 Email: formby@abode-group.co.uk
 Web: www.abode-group.co.uk