



Iverson Road, NW6

£449,950

This two bedroom flat is located on the first floor of this Victorian Building and will be a perfect first time purchase. The property has a share of freehold and will be sold with no onward chain.

Iverson Road is a popular tree-lined street which provides easy access to West End Lane with a variety of shops, bars and restaurants including all the various transport links that West Hampstead has to offer.

Features

- Two Bedrooms
- First Floor
- Share Of Freehold
- Open Plan
- Close To Station
- No Onward Chain

Iverson Road, London, NW6

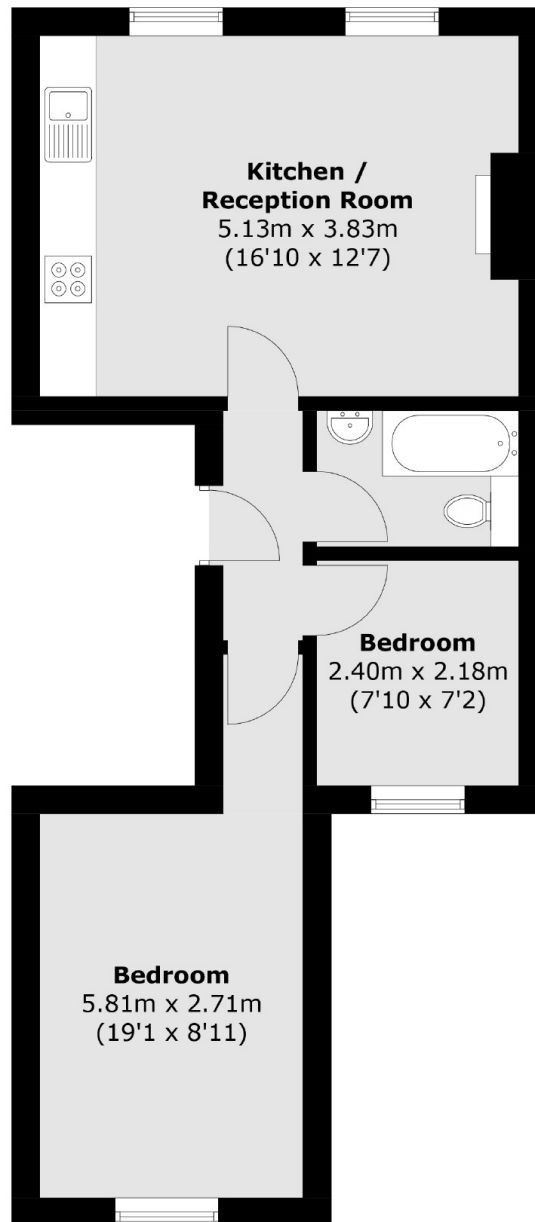

Total area (approx.): 44.6 sq. m (480.1 sq. ft)