



## Finchley Road, NW11

£450,000

An impressive one bedroom apartment located on the fourth floor (with lift) of this modern purpose built block. The property has a private balcony, additional communal roof terrace, allocated parking and it will be sold with no onward chain.

Close to Golders Green tube, Cricklewood Thameslink and a number of bus routes on the doorstep. There is also the open spaces of Hampstead Heath and Golders Hill Park close by.

### Features

- One Double Bedroom
- Private Balcony
- Allocated Parking
- Lift Access
- Communal Roof Terrace
- No Onward Chain

Finchley Road,  
London, NW11

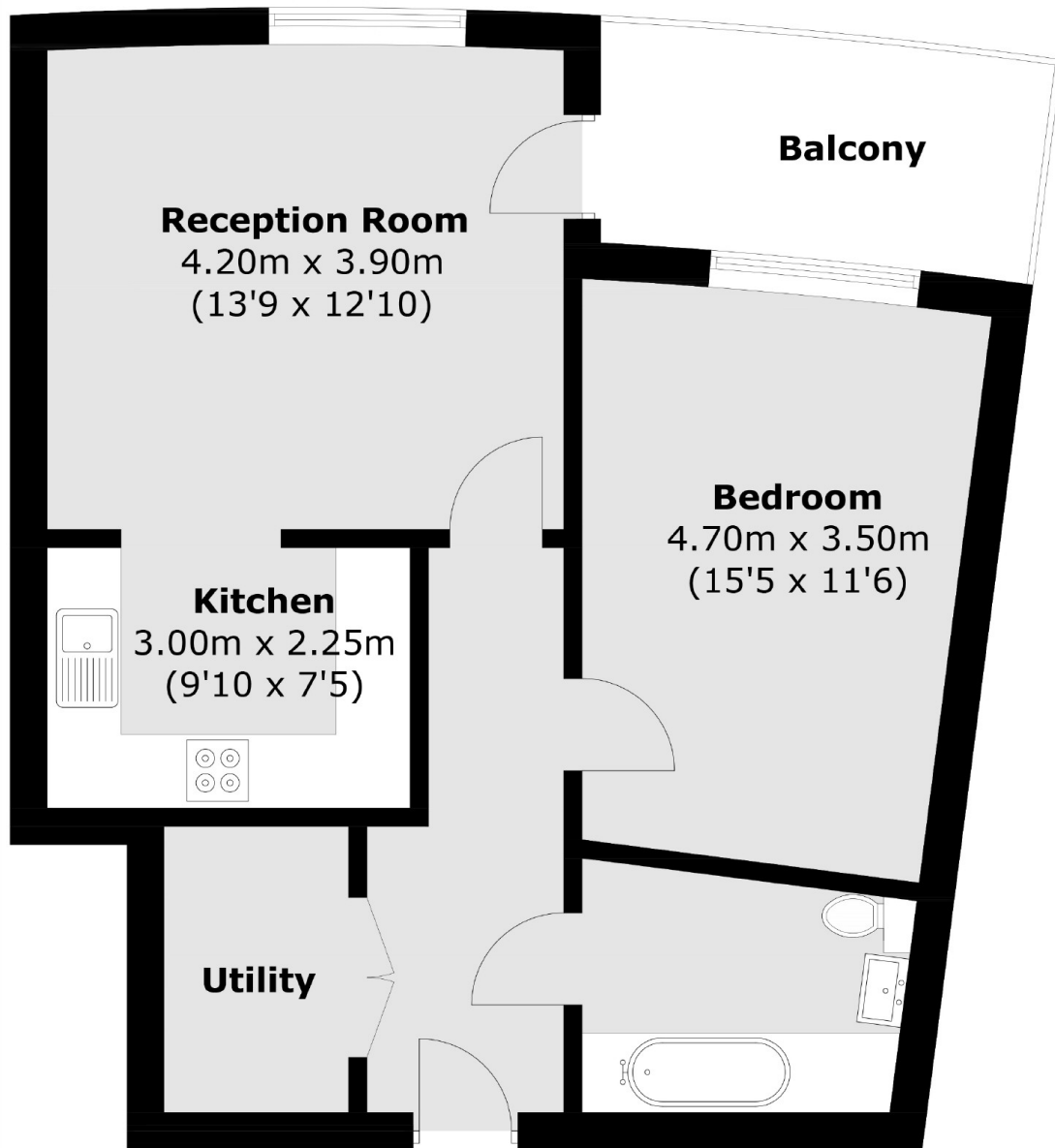

Total area (approx.): 54.9 sq. m (590.9 sq. ft)  
Balcony area (approx.): 6.5 sq. m (69.9 sq. ft)

**Dexters**

West Hampstead Sales  
349 West End Lane  
London  
NW6 1LT  
Sales  
020 7644 9300

Energy Rating: B. We aim to make our particulars both accurate and reliable. However they are not guaranteed; nor do they form part of an offer or contract. If you require clarification on any points then please contact us, especially if you're traveling some distance to view. Please note that appliances and heating systems have not been tested and therefore no warranties can be given as to their good working order.

 **RICS** | Regulated  
Estate Agent  
and Letting Agent

[dexters.co.uk](https://www.dexters.co.uk)