



Hendon Way, NW2

£550,000

A rare opportunity to purchase a large detached bungalow with a drive way for multiple cars. The property would be ideal for someone looking to downsize with lateral space and the added benefits of two bathrooms, a study and it will be sold with no onward chain.

Hendon Way is ideally located with easy access to Brent Cross station (Northern Line) as well as Golders Green and Cricklewood with both their underground and overground stations, numerous shops, cafés and restaurants. Road connections include the A40, A406 and the M1 motorway.

Features

Bungalow
Off Street Parking
Two Bathrooms
Detached
Office
No Onward Chain

Hendon Way,
London, NW2

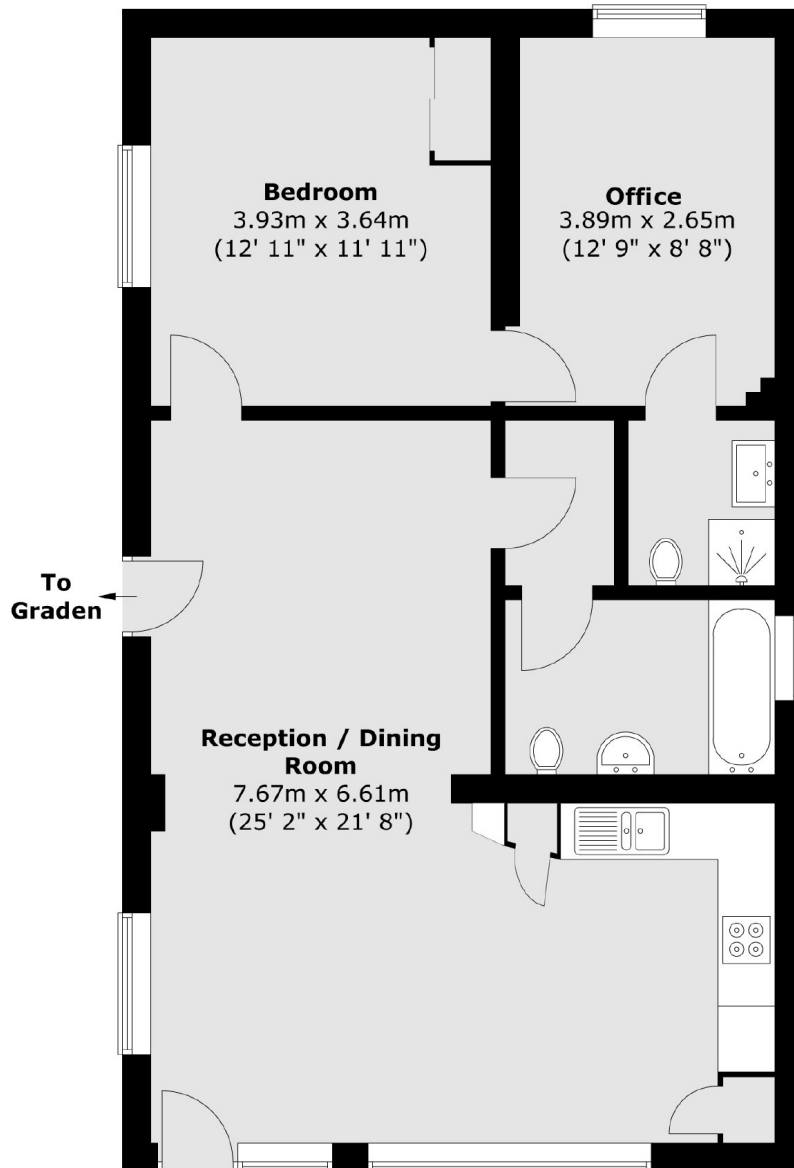

Total area (approx.) : 77.6 sq. m (835 sq. ft)

Dexters

West Hampstead Sales
349 West End Lane
London
NW6 1LT
Sales
020 7644 9300

Energy Rating: E. We aim to make our particulars both accurate and reliable. However they are not guaranteed; nor do they form part of an offer or contract. If you require clarification on any points then please contact us, especially if you're traveling some distance to view. Please note that appliances and heating systems have not been tested and therefore no warranties can be given as to their good working order.

 **RICS** | Regulated
Estate Agent
and Letting Agent

dexters.co.uk