



## Cotleigh Road, NW6

£500,000

This two bedroom garden flat would make an ideal first time purchase. The property is located on the ground floor of this converted Victorian building and it will be sold with a long lease and no onward chain

Cotleigh Road is ideally located for the local shops, restaurants and amenities of West End Lane, whilst a combination of Jubilee, Overground and Thameslink transport links can be found within close proximity at West Hampstead.

### Features

- Two Bedrooms
- Private Garden
- Long Lease
- Ground Floor
- Victorian Conversion
- No Onward Chain

# Cotleigh Road, London, NW6

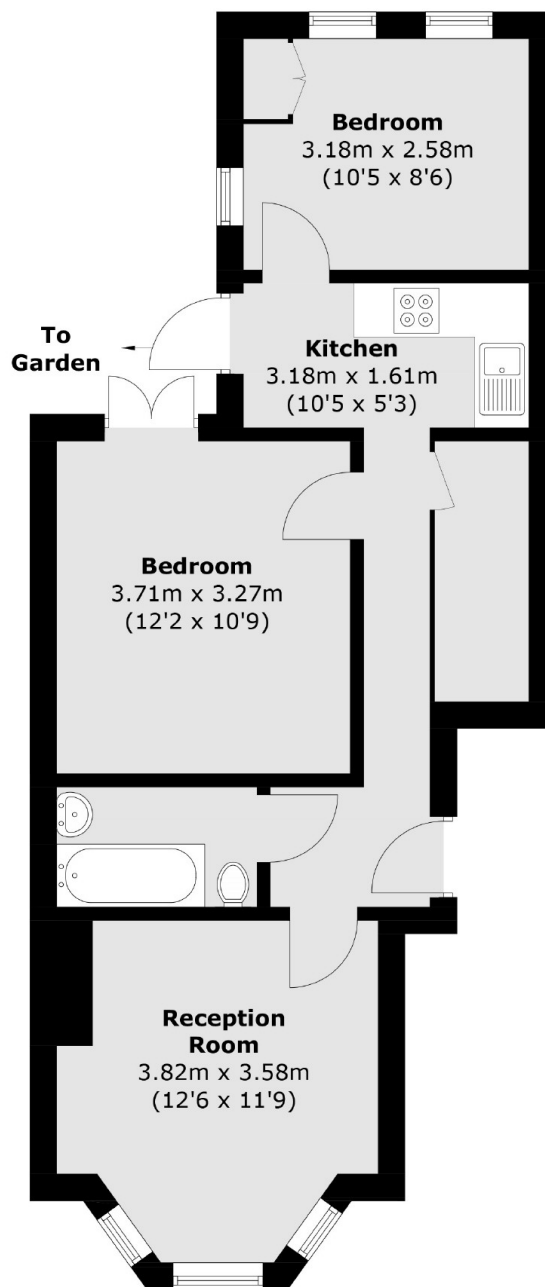

Total area (approx.): 52.1 sq. m (560.8 sq. ft)