

## Loveridge Road, NW6

£399,950

This one double bedroom flat would make an ideal first time purchase. The property is located on the first floor of this converted Victorian building and it will be sold with no onward chain.

West Hampstead stations (Thameslink, Jubilee line and overground lines) are a short walk away. This property is conveniently located for the multiple shops, restaurants and amenities of both West Hampstead and Kilburn.

### Features

- One Bedroom
- First Floor
- High Ceilings
- Separate Kitchen
- Bay Window
- No Onward Chain

# Loveridge Road, London, NW6

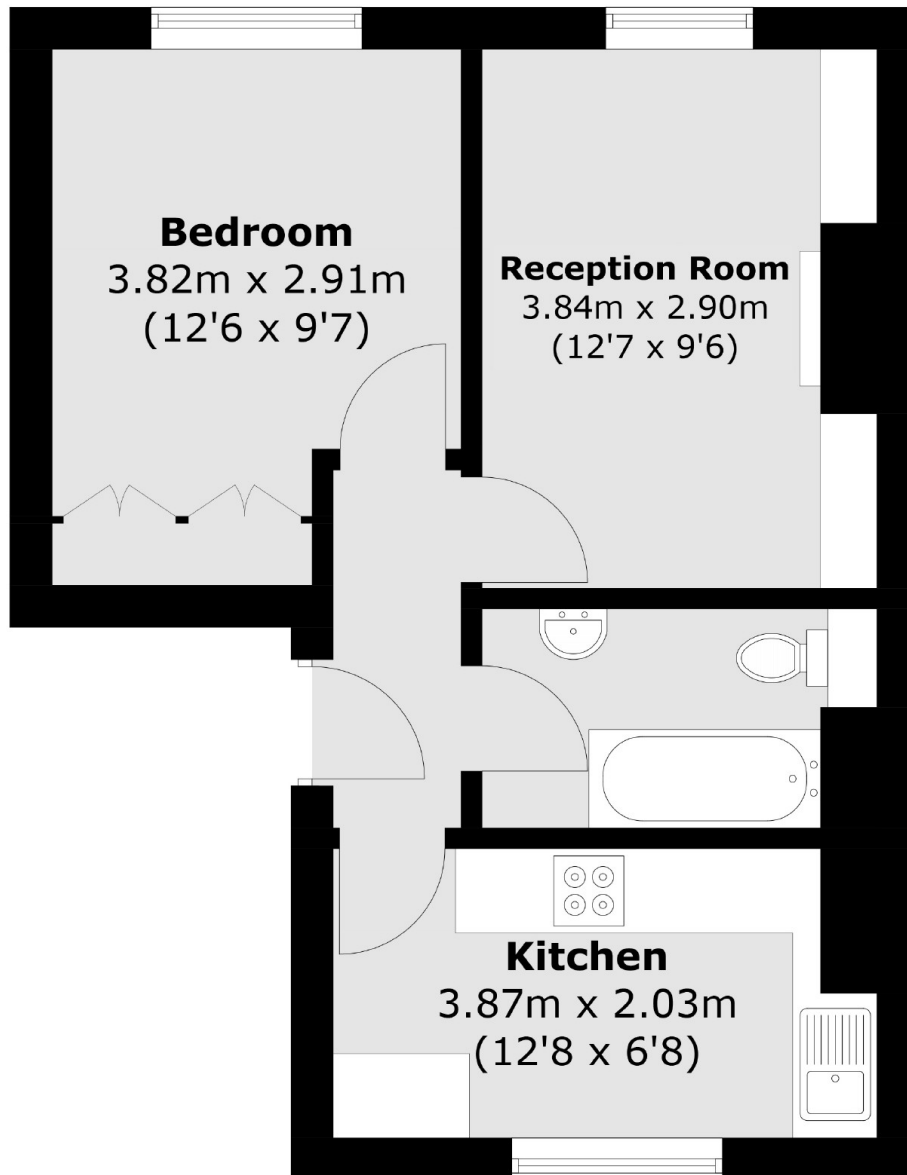

Total area (approx.): 37.8 sq. m (406.9 sq. ft)