



Finchley Road, NW11

£650,000

A newly refurbished three bedroom apartment set on the first floor of this Victorian house. This property has an open plan kitchen/ living room, two bathrooms and it will be sold with no onward chain.

Close to Golders Green tube, Cricklewood Thameslink and a number of bus routes on the doorstep. There is also the open spaces of Hampstead Heath and Golders Hill Park close by.

Features

- Three Double Bedrooms
- Two Bathrooms
- Excellent Condition
- Fantastic Transport Links
- Open Plan
- No Onward Chain



Finchley Road, NW11



Finchley Road, London, NW11

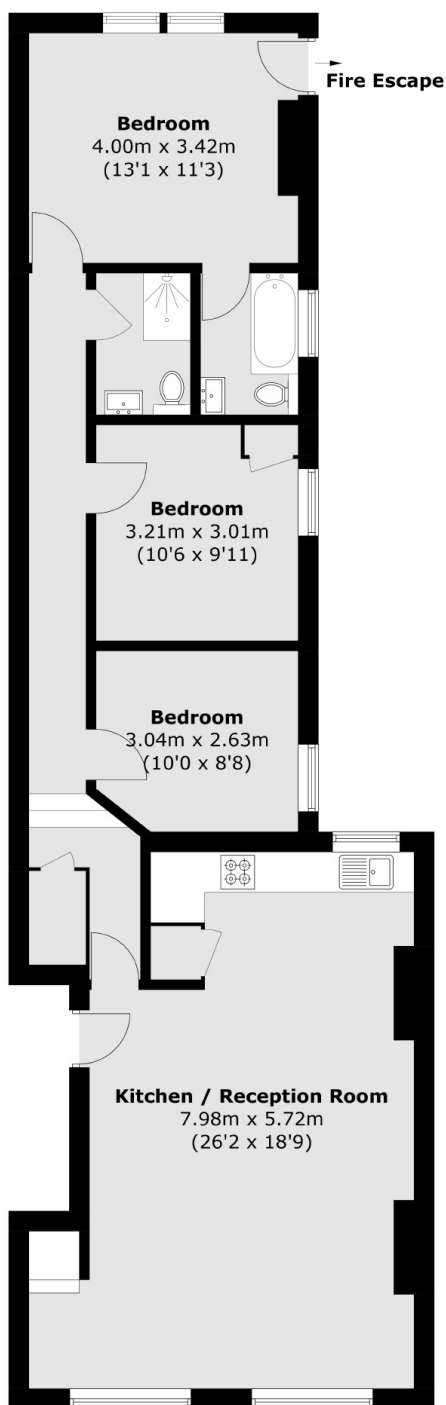

Total area (approx.): 91.0 sq. m (979.5 sq. ft)