



Nant Road, NW2
£1,350,000

Dexters



Nant Road, NW2

This five bedroom detached house backs onto Childs Hill Park and would make an ideal family home. The house has further potential to extend subject to relevant permission and has a garage and off street parking on the drive.

As you enter the front door you will find a reception room to the front of the house with bay window and fireplace. There is a spacious open plan kitchen reception room to the rear of the house which is ideal for entertaining guests, this also leads onto a conservatory with french doors leading onto the garden.

There is a double bedroom or further reception room on the ground floor with sliding doors leading onto the garden and a shower room. You will find two double bedrooms on the first floor with a three piece bathroom, guest W/C and a further two bedrooms on the second floor.

The property further benefits from a garage, parking on the drive way and views onto Childs Hill Park.

Nant Road is a quiet cul de sac and is situated between Golders Green and Hampstead in the residential area of Childs Hill. Golders Green is within walking distance providing a wide range of transport, shops and amenities.

Features

Detached

Garage

Five Bedrooms

Two Bathrooms

Off Street Parking

Scope To Extend







Nant Road, London, NW2

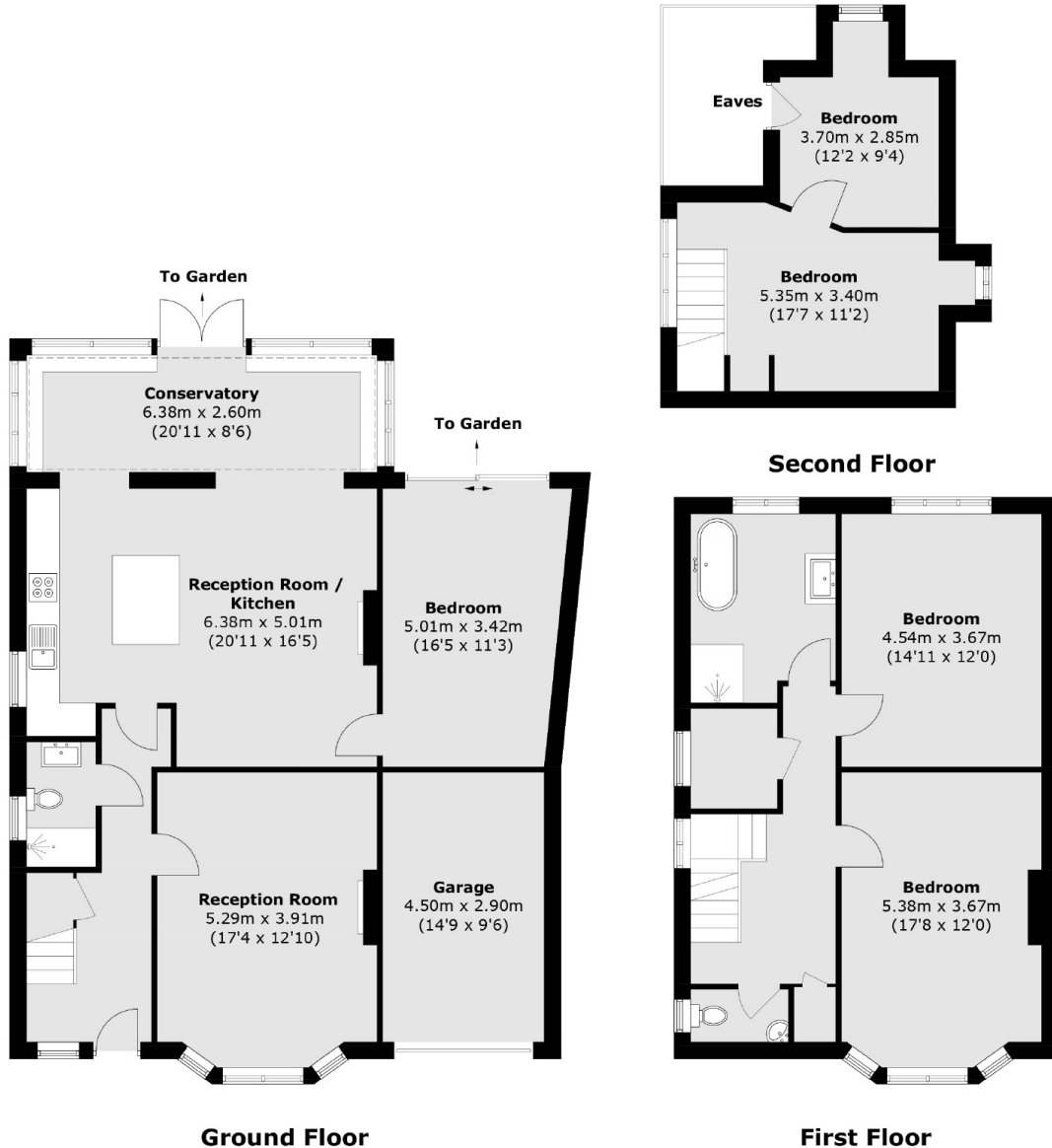

Total area (approx.): 180.7 sq. m (1,945.0 sq. ft)
Garage: 14.1 sq. m (151.8 sq. ft)
(Excluding Eaves)