



## Willesden Lane, NW6

£475,000

A well-proportioned two bedroom apartment, set on the second floor of this modern block. This property has an open plan kitchen/reception room, two bathrooms, a private balcony and a lift.

Willesden Lane is close to the shops, bars and restaurants of both Kilburn High Road and Willesden Lane. Transport links can be found at Kilburn Park (Bakerloo line), Kilburn (Jubilee line) and Kilburn High Road (Overground).

### Features

- Two Double Bedrooms
- Two Bathrooms
- Lift
- Excellent Transport Links
- Close to Amenities
- Private Balcony

# Willesden Lane, London, NW6

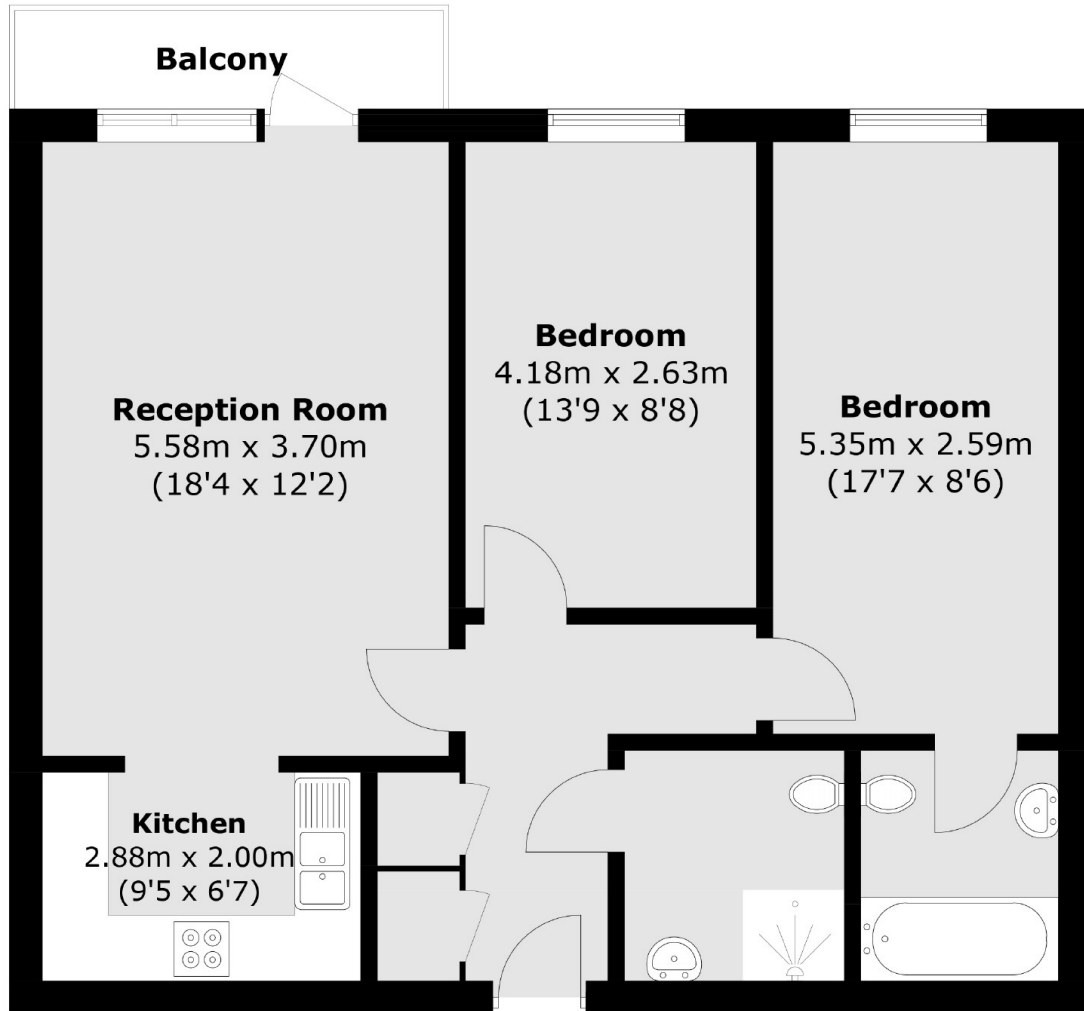

## Second Floor

Total area (approx.): 71.0 sq. m (764.2 sq. ft)  
Balcony: 3.5 sq. m (38 sq. ft)