



Buckley Road, NW6

£549,950

This spacious three bedroom flat is located on the second and third floors of this Victorian building and offers over 900 sq ft. The property has two bathrooms and has a share of freehold.

Buckley Road is ideally located close to the numerous shops, cafés and restaurants of Queens Park's Salusbury Road. Excellent transport links include both Brondesbury Park and Brondesbury overground stations and Kilburn underground.

Features

Three Bedrooms
Share Of Freehold
Victorian Building
Duplex Apartment
Two Bathrooms
Close To Station



Buckley Road, NW6



Buckley Road, London, NW6

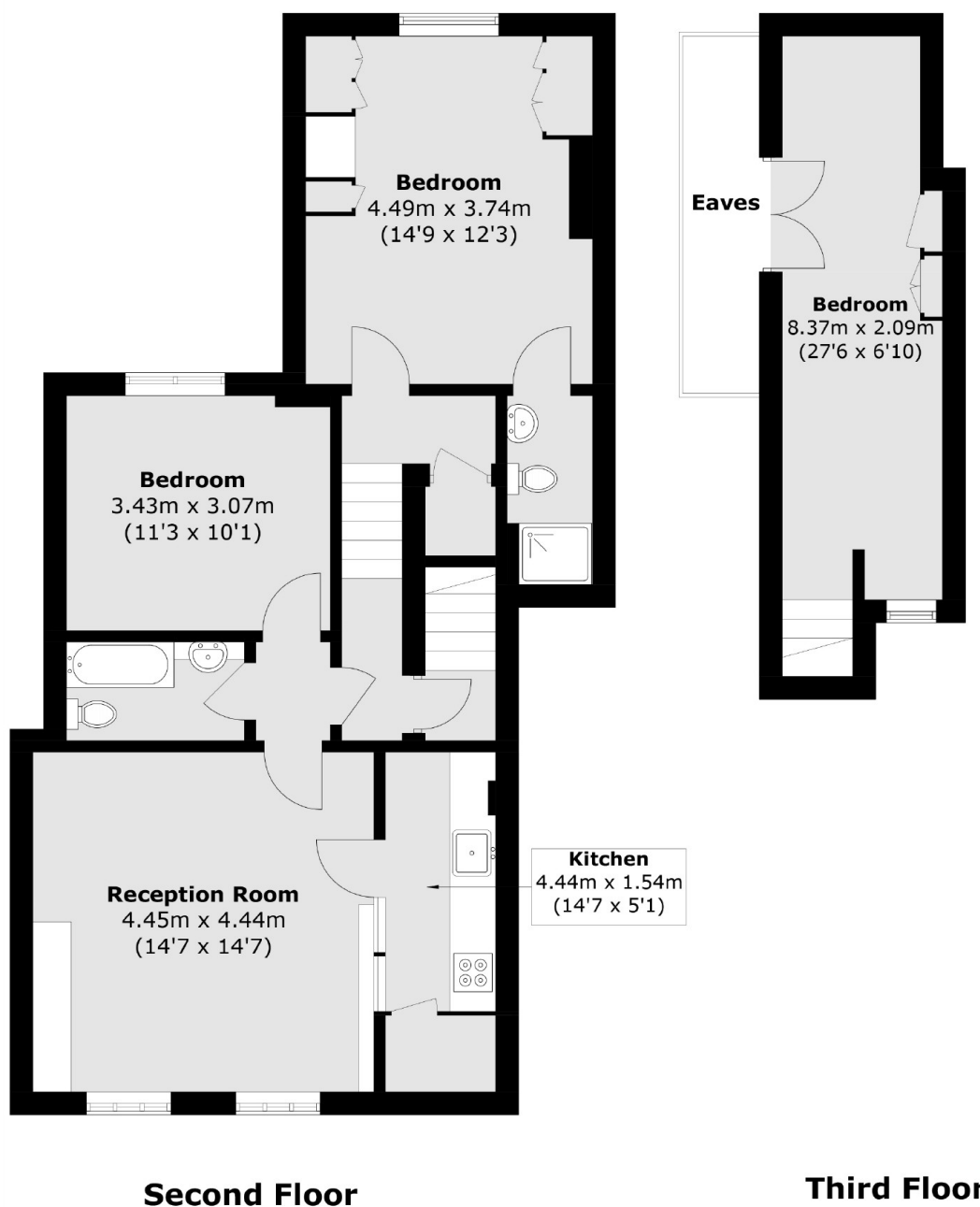

Total area (approx.): 85.0 sq. m (914.9 sq. ft)
(Excluding Eaves)