



Burton Road, NW6

£675,000

A two double bedroom garden flat, set within a semi-detached Victorian house. This property has a separate kitchen, high ceilings and direct access to a south facing private garden.

Burton Road is ideally located close to the numerous shops, cafés and restaurants of Queens Park's Salusbury Road. Excellent transport links include both Brondesbury Park and Brondesbury overground stations and Kilburn underground.

Features

- Two Double Bedrooms
- Private Garden
- Separate Kitchen
- High Ceilings
- Excellent Transport Links
- No Onward Chain



Burton Road, NW6



Burton Road, London, NW6

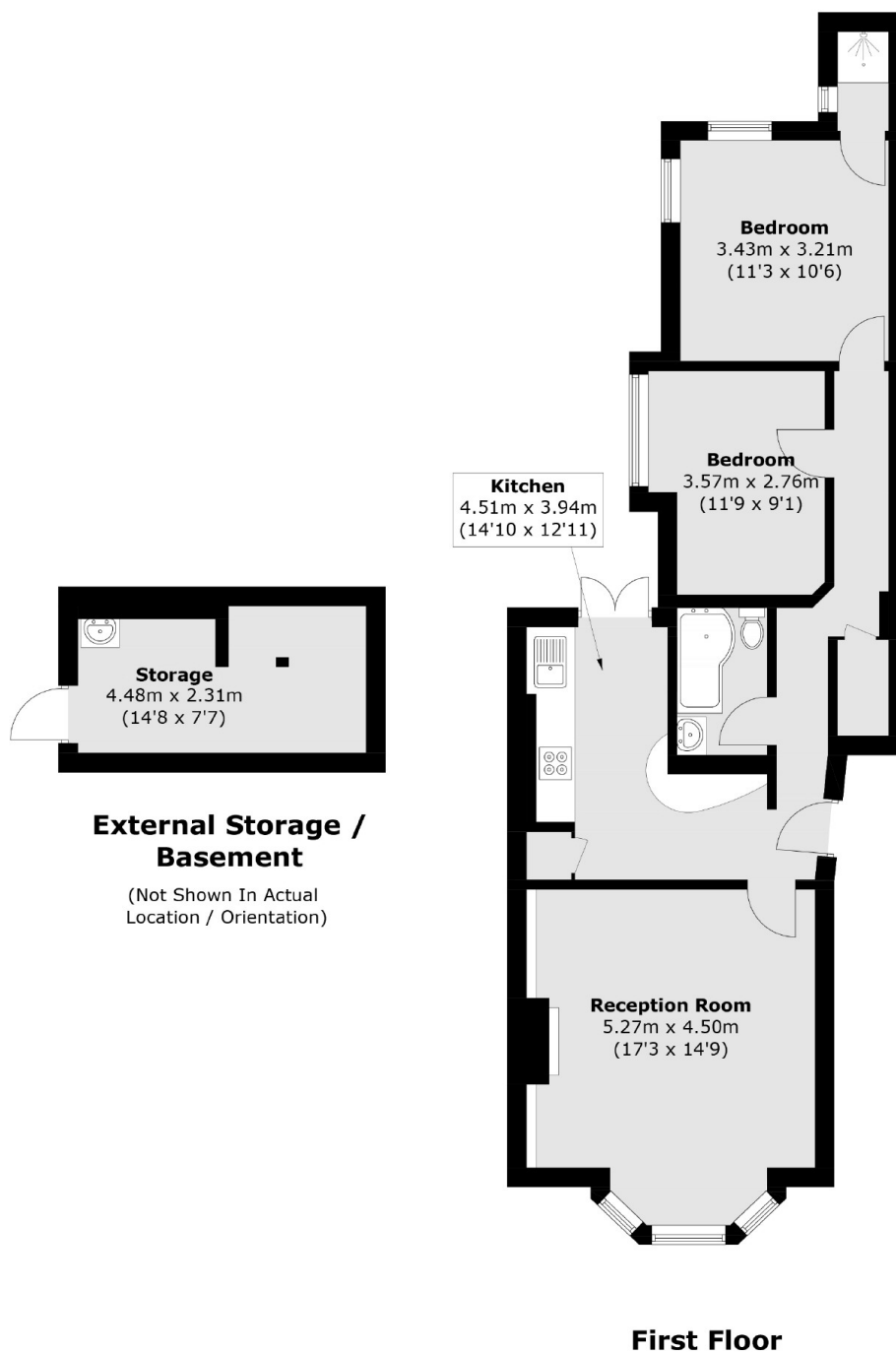

Total area (approx.): 80.0 sq. m (861.1 sq. ft)