



## West End Lane, NW6

£625,000

A spacious two bedroom apartment set within an art deco style mansion block with a beautiful dual aspect reception room and private balcony.

Kingswood Court is ideally located between South Hampstead and West Hampstead giving excellent transport links across London. West End Lane has many restaurants, cafes, and bars all within easy reach.

### Features

- Two Double Bedrooms
- Separate Kitchen
- Dual Aspect Reception
- Communal Gardens
- Bicycle Storage
- Balcony

West End Lane,  
London, NW6

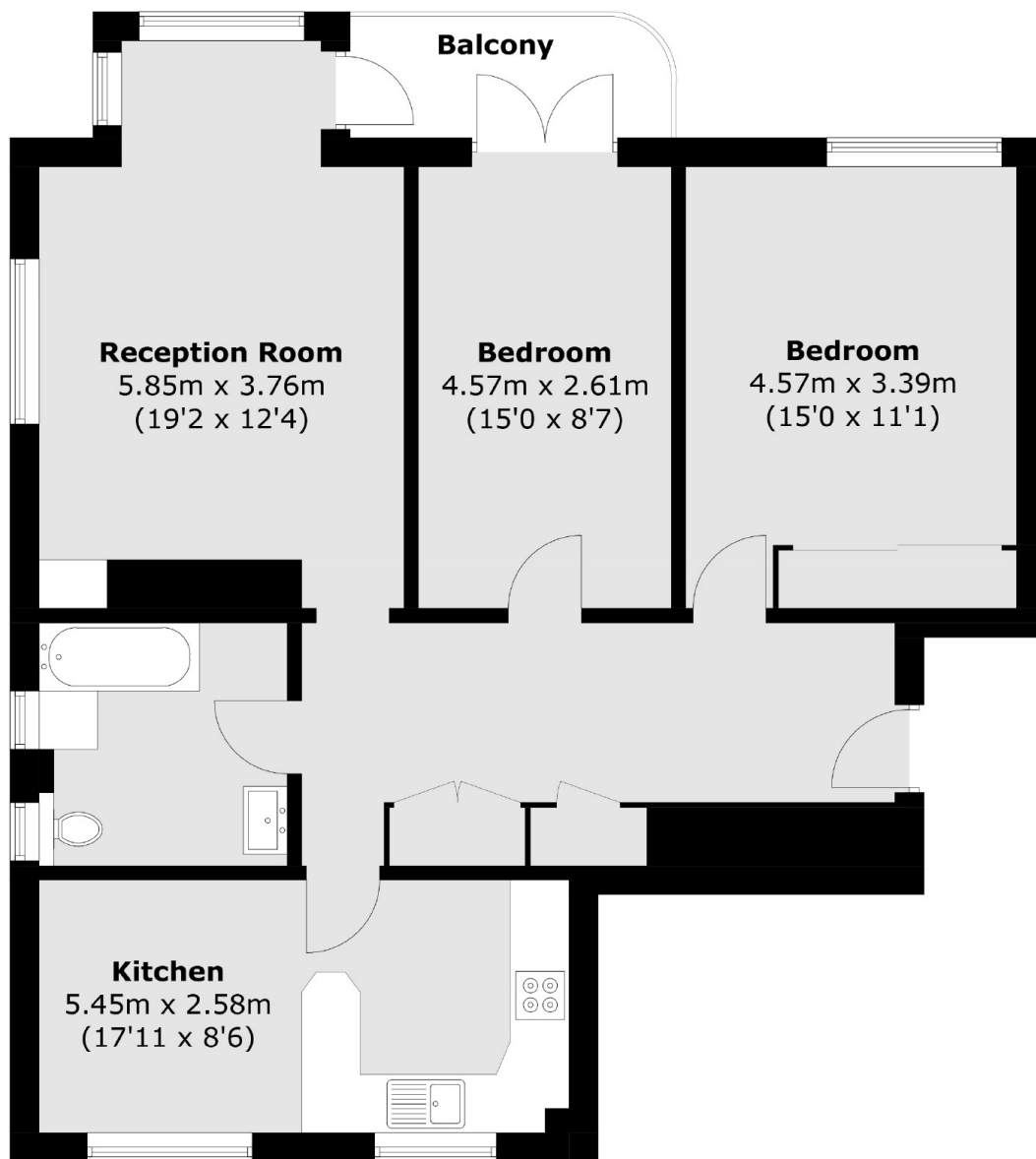

Total area (approx.): 85.5 sq. m (920.3 sq. ft)  
Balcony: 4.0 sq. m (43.0 sq. ft)