

whiteley helyar



945 ft²



2 bedrooms



bathroom



resident's
permit
parking

Guide Price £335,000

Top Floor Flat, 27 Green Park, Bath, BA1 1HZ.

A two double bedroom, top floor apartment in the very heart of the city, with wonderful park views and no onward chain. Occupying the whole floor of a Grade 2 listed Georgian townhouse, the flat sits in a peaceful location within this impressive terrace in a cul-de-sac location.

ACCOMMODATION

Spacious entrance reception hall
Sitting/dining room with period fireplace and lovely park views
Kitchen with integrated oven & hob
Two double bedrooms
Bathroom

LOCATION

The apartment occupies a peaceful position in a 'no through' road in the very heart of the Georgian city of Bath, within easy reach of Bath Spa Railway station and the huge variety of shops and amenities that the city centre has to offer.







Tenure: Share of freehold
Service charge: £150 per month
Council Tax Band: 'C' - £1,968.48



Energy Efficiency Rating		
	Current	Potential
Very energy efficient - lower running costs		
A (91-100)		
B (81-90)		
C (69-80)		
D (55-68)		
E (39-54)		
F (21-38)		
G (1-20)		
Not energy efficient - higher running costs		
England & Wales	71	76
EU Directive 2002/91/EC		

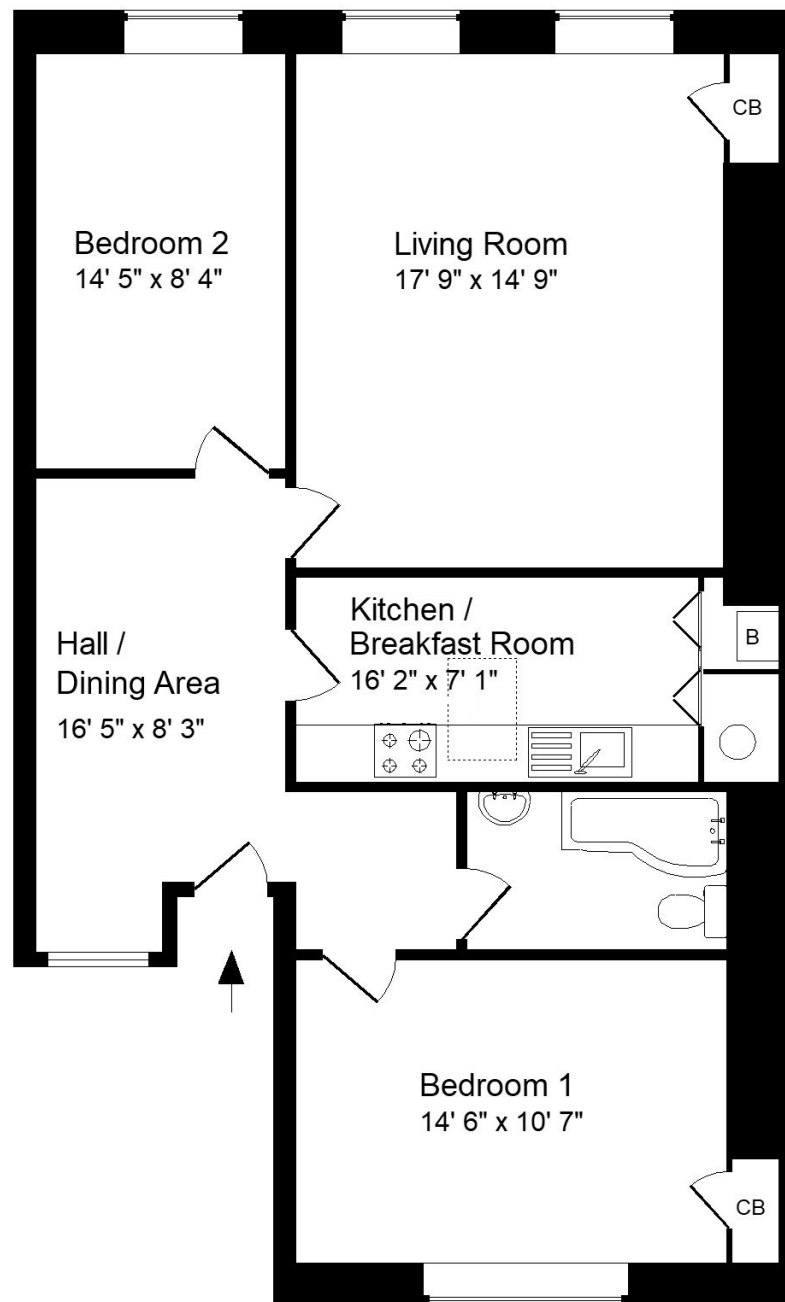

Approx. Gross Internal Floor Area 945 Sq. Ft. / 88 Sq. M
 Includes Conservatories. Excludes Garages, Porches etc. unless stated
 For indication purposes only. Not to scale. Copyright Jemesis Ltd 2010
 Drawing Number:172-422j
 Top Floor Flat. 27 Green Park, Bath. BA1 1HZ