

# whiteley helyar



793 ft<sup>2</sup>



2 double  
bedrooms



2 bathrooms



residents  
permits  
available

Guide Price                      £550,000

Flat 2, Beckford House, 66 Great Pulteney Street, Bath, BA2 4DL

A really beautifully presented ground floor apartment with a private front door directly on Great Pulteney Street, contained within an elegant Grade I Listed Georgian townhouse in this prime location. Just a few minutes level walk from Pulteney Bridge and the centre of Bath, the apartment enjoys a lovely southerly outlook and delightful period features (including sash windows, high ceilings, decorative cornicing and fireplaces).

### ACCOMMODATION

private entrance hall  
2 double bedrooms  
bathroom  
en-suite shower room  
large loft storage space

further communal entrance hall  
20'1 x 17'7 sitting room/kitchen  
utility room  
gas fired heating  
residents parking permits available

### LOCATION

The apartment stands in one of the most sought after, select and convenient positions in the city. Situated just over Pulteney Bridge, it is only a very short level stroll from Waitrose, Bath Recreation Rugby Ground, Bath Spa Railway Station and the countless shops and amenities in this World Heritage City. Wonderful walks are available through nearby Henrietta Park and Sydney Gardens, as well as along the Kennet and Avon Canal towpath or banks of the River Avon.





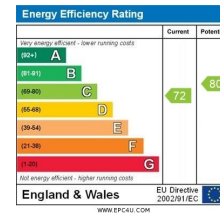

**Tenure: Share of Freehold**  
**Service Charge 2025/26: £4,185.96**  
**Council Tax Band: 'D' - £ 2,214.54**

Ground Floor

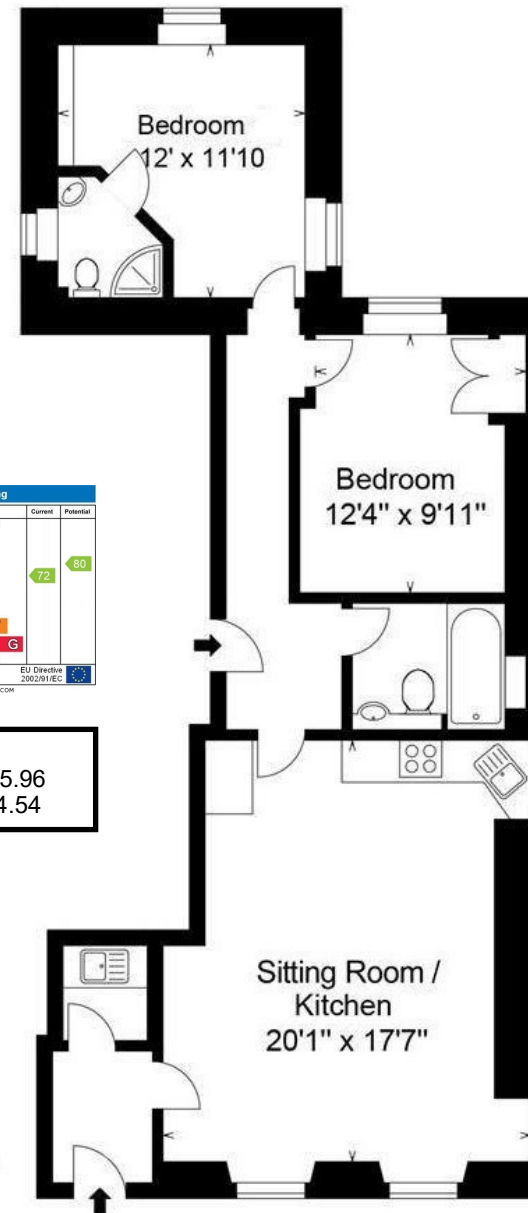

Approx. Gross Internal Area  
 793 Sq Ft - 74.67 Sq M

Whilst every attempt has been made to ensure the accuracy of the floorplan contained here, measurements of doors, windows, rooms and any other items are approximate and no responsibility is taken for any error, omission or mis-statement.  
 This plan is purely for illustrative purposes only and should be used as such by any prospective purchaser.