

whiteley helyar



788 ft²



2 bedrooms



bathroom



resident's
parking
permit

Guide Price £425,000

Flat 7, 14 Alfred Street, Bath, BA1 2QX

A two double bedroom, spacious top floor apartment in this most central of locations, boasting stunning views over the city centre and offered with no onward chain. Beautifully renovated, the end of terrace nature of the building means that there are windows to three sides, creating a wonderfully light and modern home.

ACCOMMODATION

Sitting room with panoramic southerly views over the city centre

Contemporary fitted kitchen

Two double bedrooms, both with fitted wardrobes

Modern bathroom

LOCATION

The apartment occupies a most convenient, select and highly sought after position, opposite the Assembly Rooms and only a very short walk from Milsom Street and the heart of the city. The various shops, galleries and restaurants in Brock Street and the pedestrianised Margaret's Buildings are nearby, whilst the Recreation Ground and fabulous Royal Victoria Park (with its Botanical Gardens, extensive children's play area, tennis courts, pitch and putt and crazy golf) are also extremely close to hand.





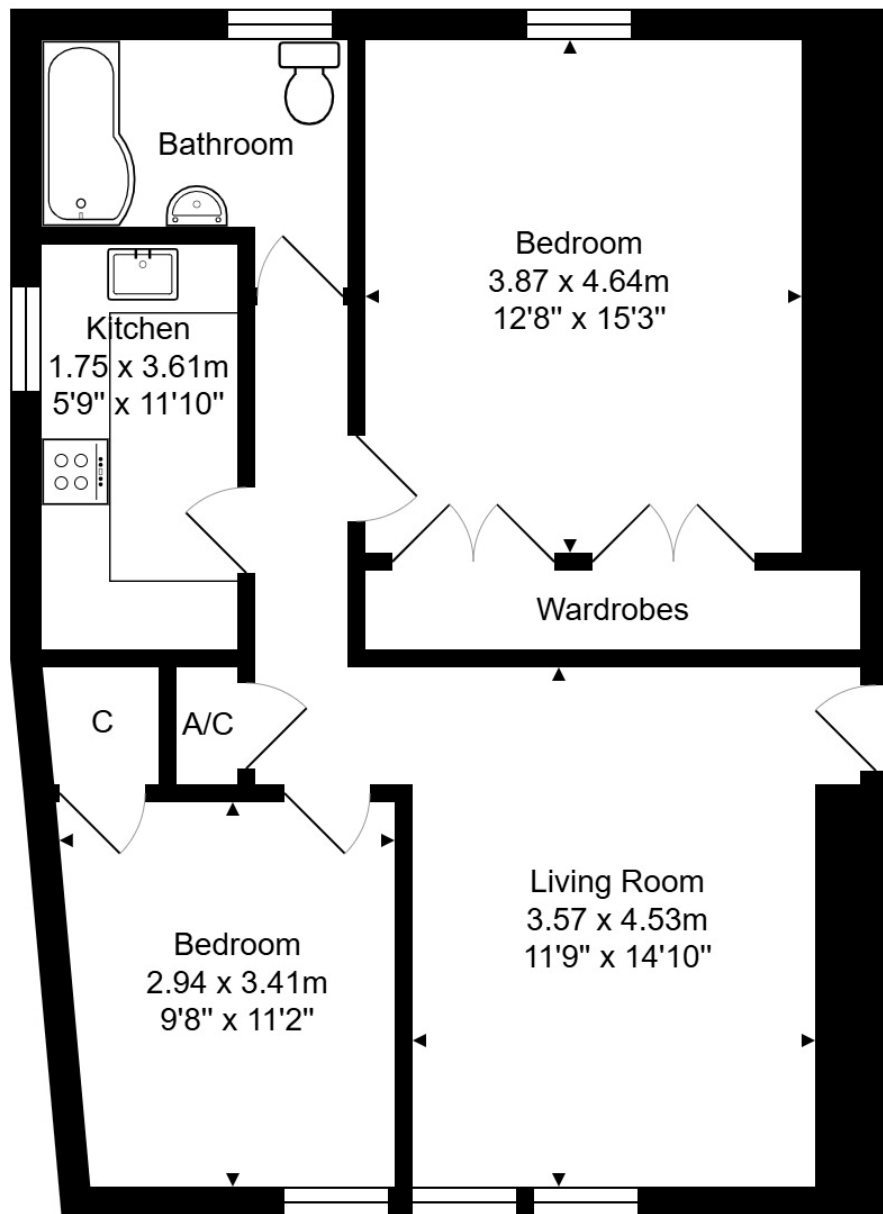

Total Area: 73.2 m² ... 788 ft²

Whilst every attempt has been made to ensure the accuracy of the floorplan contained here, measurements of doors, windows, rooms and any other items are approximate and no responsibility is taken for any error, omission or mis-statement.

This plan is purely for illustrative purposes only and should be used as such by any prospective purchaser.

Area includes internal and external wall thickness

www.epcassessments.co.uk

Tenure: Leasehold

Lease length: 999 yrs from 24th June 1981

Service Charge: £1,800 pa

Council Tax Band: 'C' - £1,968.48



Energy Efficiency Rating		
	Current	Potential
Very energy efficient - lower running costs		
(92+) A		
(81-91) B		
(69-80) C		
(55-68) D		
(39-54) E		
(21-38) F		
(1-20) G		
Not energy efficient - higher running costs		
England & Wales		
	EU Directive 2002/91/EC	

www.epc4u.com

