

whiteley helyar



585 ft²



2 bedrooms



bathroom



resident's
permit
parking

Guide Price £350,000

Flat 2, Fountain House, 9-11 Fountain Buildings, Bath, BA1 5DU

A stunning two double bedroom, first floor apartment with lift access in this most central of locations and offered with no onward chain. Renovated to a very high standard, and featuring bespoke carpentry, this wonderful flat would make a great first home or

ACCOMMODATION

entrance hall
kitchen/reception room with integrated appliances and panelled walls
two double bedrooms, one with a range of fitted wardrobes
contemporary bathroom

LOCATION

The apartment occupies a superb location in the centre of the city, most conveniently located just a couple of minutes walk from Milson Street. The extensive range of shops, amenities, parks, sports facilities and transport links are within easy walking distance.





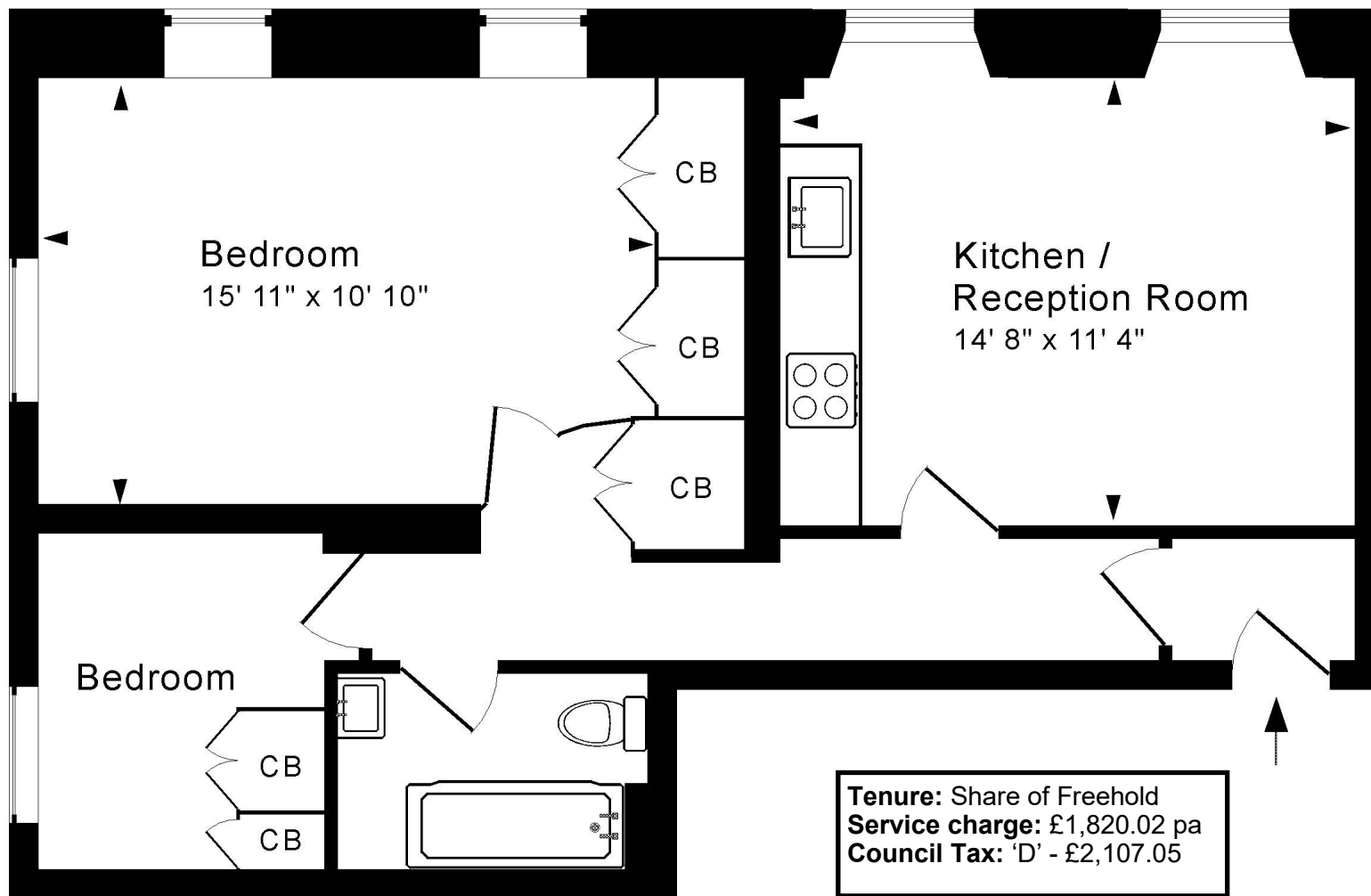

First Floor

Approx. Gross Internal Floor Area 585 Sq. Ft. / 54 Sq. M

Includes Conservatories. Excludes Garages, Porches etc. unless stated

For identification purposes only. Not to scale.

Copyright Jemesis Ltd 2025

Drawing Number: 172-0807

Flat 2, Fountain House, 9-11 Fountain Buildings, Bath, BA1 5DU.

