

whiteley helyar



615 ft²



2 bedrooms



shower-room



residents permit
available

Guide Price £400,000

First Floor Flat, 19, Brock Street, Bath, BA1 2LW

DESCRIPTION

A charming apartment occupying the first floor of this elegant Listed town house, adjacent to Royal Crescent and most pleasantly located this highly sought after road in the centre of Bath.

ACCOMMODATION

2 bedrooms (one with attractive bow window)
fitted kitchen
gas fired heating

shower room
living room (with feature window)
residents parking permit available (central zone)

LOCATION

Brock Street is a wonderful, most desirable location right in the heart of the city, linking Royal Crescent with The Circus. There are a number of fine restaurants, shops and galleries very close to hand, whilst in addition to the countless amenities in the centre of Bath, the property is within walking distance of Bath Spa Railway Station and Bath Rugby Recreation Ground. Royal Victoria Park (with its fabulous grounds, Botanical Gardens, golf, tennis courts and extensive children's play area) and Royal Crescent Lawns are literally 'on your doorstep' whilst swift access to the M4 is also available without having to cross the city.





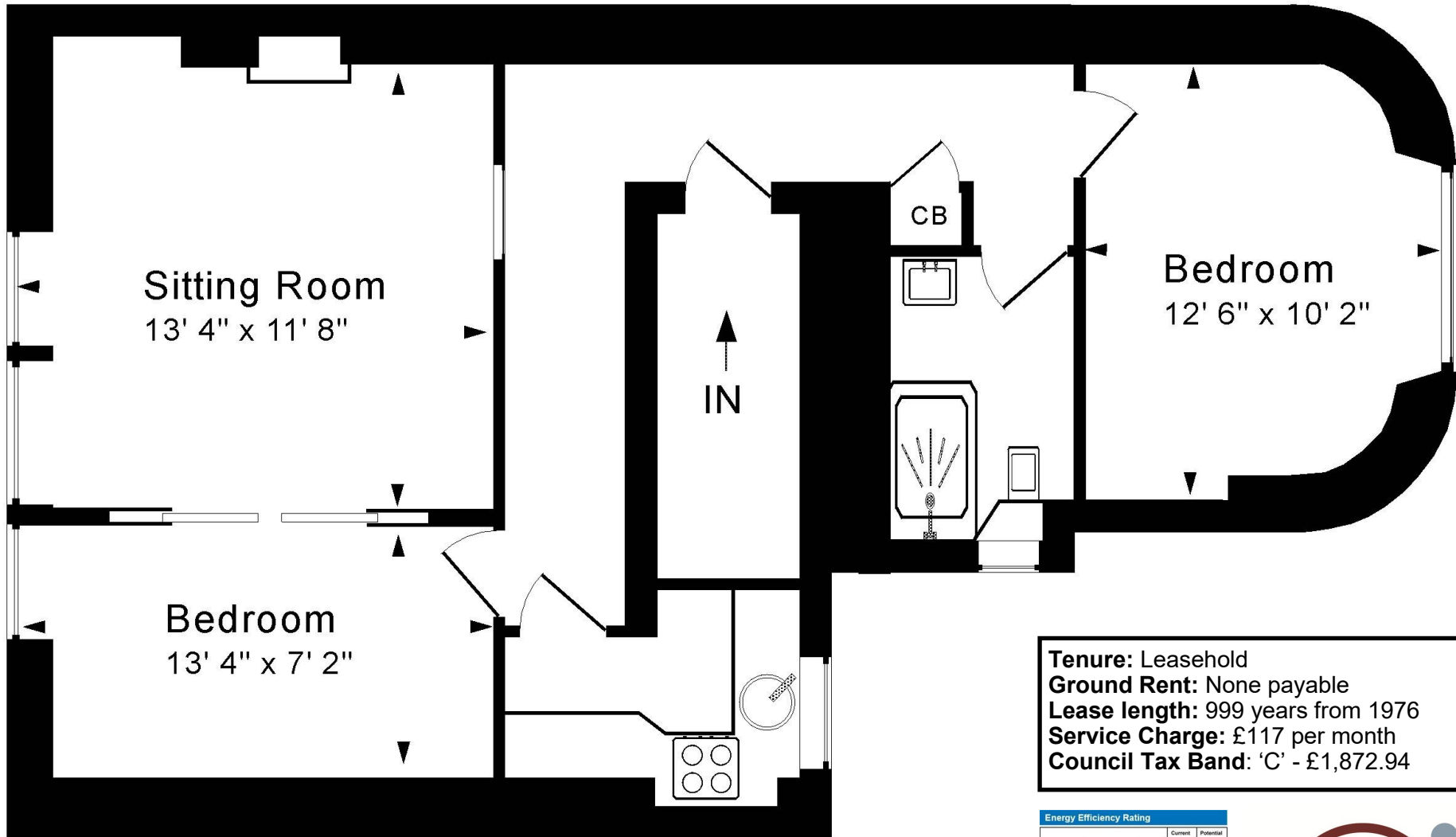

Tenure: Leasehold
Ground Rent: None payable
Lease length: 999 years from 1976
Service Charge: £117 per month
Council Tax Band: 'C' - £1,872.94

Approx. Gross Internal Floor Area 615 Sq. Ft. / 57 Sq. M

For identification purposes only. Not to scale.

Copyright Jemesis Ltd 2025

Drawing Number:172-0705

Flat 2, 19 Brock Street, Bath, BA1 2LW.

