



## Coles Green Road, London NW2

£1,250 pcm

**\*\* Available now - All Bills Inclusive of rent! \*\***

Welcome to Coles Green Road; a selection of five stunning brand new units in shared accommodation with a huge landscaped communal garden and amenities for residents to enjoy in a quiet residential area!

- Excellent Condition
- Brand New
- Good residential location
- All Bills Inclusive
- Bright and Airy
- Private Bathroom
- Communal Kitchen
- Huge Landscaped Communal Garden
- Work from home office space within working hours
- Close to shops and local amenities

# COLES GREEN ROAD, NW2 7ES

Approximate Gross Internal Area = 16.7 sq.m / 180 sq.ft

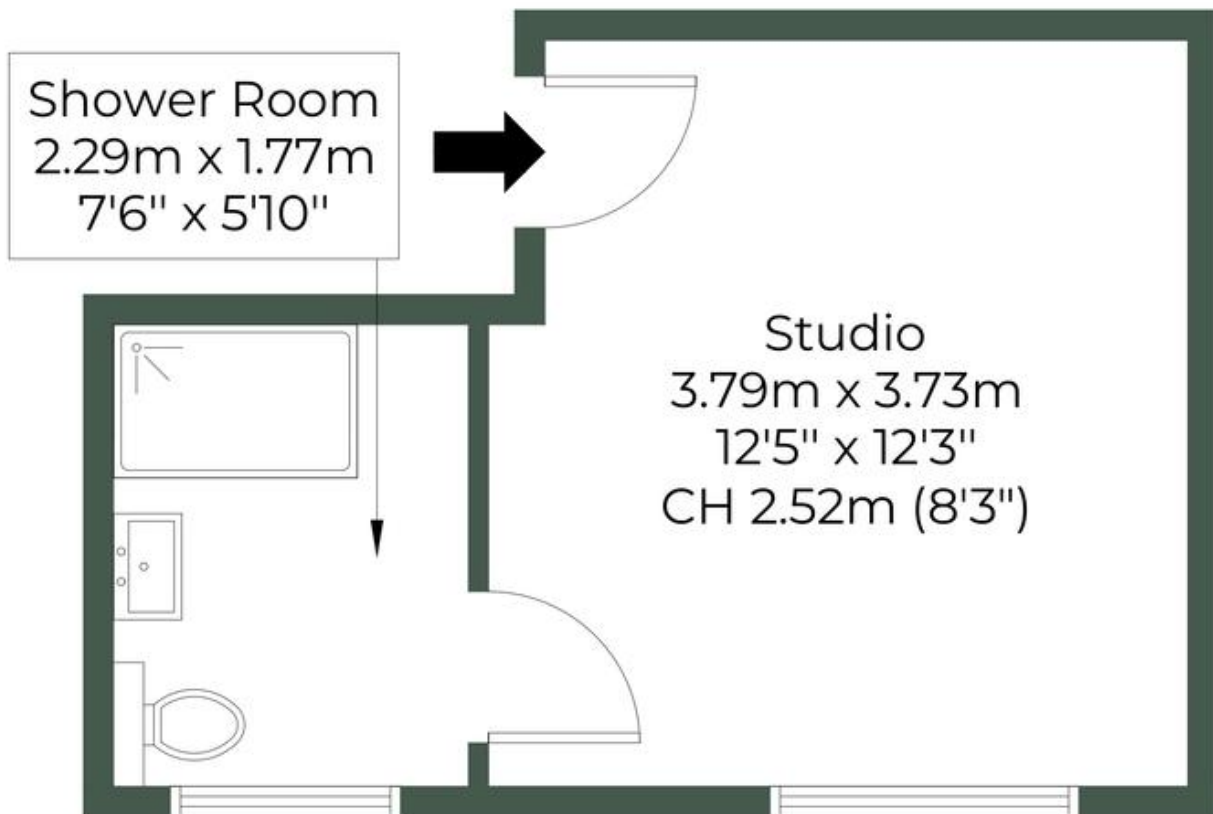
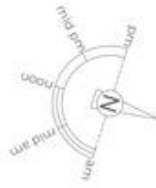

## First Floor